

DATE: 11/06/14 TIME: 3:02:24 PM DRAWING NAME: E152 - SUNDOWN SKI JUMP Dwg
 DRAWER: NONE PLOT SETUP: --- LAYOUT: LAYOUT 01
 PLOT: N:\2014\11\06\14\152\152.DWG PLOT DATE: 11/06/14 PLOT USER: III

EROSION CONTROL GENERAL NOTES:

THE CONTRACTOR TO USE BEST MANAGEMENT PRACTICES FOR PROVIDING EROSION CONTROL FOR CONSTRUCTION OF THIS PROJECT. ALL MATERIAL AND WORKMANSHIP SHALL CONFORM TO WEBER COUNTY ORDINANCES AND ALL WORK SHALL BE SUBJECT TO INSPECTION BY THE COUNTIES. ALSO, INSPECTORS WILL HAVE THE RIGHT TO CHANGE THE FACILITIES AS NEEDED.

CONTRACTOR SHALL KEEP THE SITE WATERED TO CONTROL DUST. CONTRACTOR TO LOCATE A NEARBY HYDRANT FOR USE AND TO INSTALL TEMPORARY METER. CONSTRUCTION WATER COST TO BE INCLUDED IN BID.

WHEN GRADING OPERATIONS ARE COMPLETED AND THE DISTURBED GROUND IS LEFT "OPEN" FOR 14 DAYS OR MORE, THE AREA SHALL BE FURROWED PARALLEL TO THE CONTOURS.

THE CONTRACTOR SHALL MODIFY EROSION CONTROL MEASURES TO ACCOMMODATE PROJECT PLANNING.

ALL ACCESS TO PROPERTY WILL BE FROM PUBLIC RIGHT-OF-WAYS.

MAINTENANCE:

ALL BEST MANAGEMENT PRACTICES (BMP'S) SHOWN ON THIS PLAN MUST BE MAINTAINED AT ALL TIMES UNTIL VEGETATION IS RE-ESTABLISHED.

THE CONTRACTOR'S RESPONSIBILITY SHALL INCLUDE MAKING BI-WEEKLY CHECKS ON ALL EROSION CONTROL MEASURES TO DETERMINE IF REPAIR OR SEDIMENT REMOVAL IS NECESSARY. CHECKS SHALL BE DOCUMENTED AND COPIES OF THE INSPECTIONS KEPT ON SITE.

SEDIMENT DEPOSITS SHOULD BE REMOVED AFTER EACH RAINFALL. THEY MUST BE REMOVED WHEN THE LEVEL OF DEPOSITION REACHES APPROXIMATELY ONE-HALF THE HEIGHT OF BARRIER.

SEDIMENT TRACKED ONTO PAVED ROADS MUST BE CLEANED UP AS SOON AS PRACTICAL, BUT IN NO CASE LATER THAN THE END OF THE NORMAL WORK DAY. THE CLEAN UP WILL INCLUDE SWEEPING OF THE TRACKED MATERIAL, PICKING IT UP, AND DEPOSITING IT TO A CONTAINED AREA.

EXPOSED SLOPES:

ANY EXPOSED SLOPE THAT WILL REMAIN UNTOUCHED FOR LONGER THAN 14 DAYS MUST BE STABILIZED BY ONE OR MORE OF THE FOLLOWING METHODS:

- A) SPRAYING DISTURBED AREAS WITH A TACKIFIER VIA HYDROSEED
- B) TRACKING STRAW PERPENDICULAR TO SLOPES
- C) INSTALLING A LIGHT-WEIGHT, TEMPORARY EROSION CONTROL BLANKET

CONTACT PERSON:

PERSON RESPONSIBLE FOR IMPLEMENTATION OF EROSION CONTROL PLAN IS ROGER ARAVE, 801-940-0665.

SCOPE OF WORK:

PROVIDE, INSTALL AND/OR CONSTRUCT THE FOLLOWING PER THE SPECIFICATIONS GIVEN OR REFERENCED, THE DETAILS NOTED, AND/OR AS SHOWN ON THE CONSTRUCTION DRAWINGS:

 HATCHING INDICATES AREAS TO HAVE TOPSOIL STRIPPED AND BERMED ALONGSIDE THE PROJECT LIMITS. AFTER GRADING IS COMPLETE, TOPSOIL TO BE RESTORED OVER DISTURBED AREA AND TRACKED PARALLEL TO SLOPE. DISTURBED AREA TO BE RE-VEGETATED WITH SEED MIX LISTED BELOW AND APPLIED WITH SPRAYMATT BONDED FIBER MATRIX BY CENTRAL FIBER. APPLY PER MANUFACTURERS SPECIFICATIONS.

 INSTALL SILT FENCE ALONG DOWN GRADIENT LIMITS OF DISTURBANCE AS SHOWN ON PLAN.

 EXISTING GRAVEL PARKING AREA TO SERVE AS STABILIZED CONSTRUCTION ENTRANCE FOR SITE INGRESS/EGRESS. SUPPLY WATER FOR VEHICLE WASH DOWN AS NEEDED.

 LIMITS OF DISTURBANCE

- * SEED MIXTURE FOR REVEGITATION
- 40% MOUNTAIN BROME (BROMUS MARGINATUS)
 - 25% SLENDER WHEATGRASS (ELYMUS TRACHYCAULUS SSP. TRACHYCAULUS)
 - 5% SHEEP FESCUE (FESTUCA OVINA SPP. DURIUSCULA)
 - 25% ALPINE BLUEGRASS (POA ALPINE)
 - 25% THICKSPIKE WHEATGRASS (ELYMUS LANCEOLATUS SSP. LANCEOLATUS)

SEEDING RATE IS 40 POUNDS PER ACRE.

TOTAL DISTURBED AREA = 0.90 ACRES

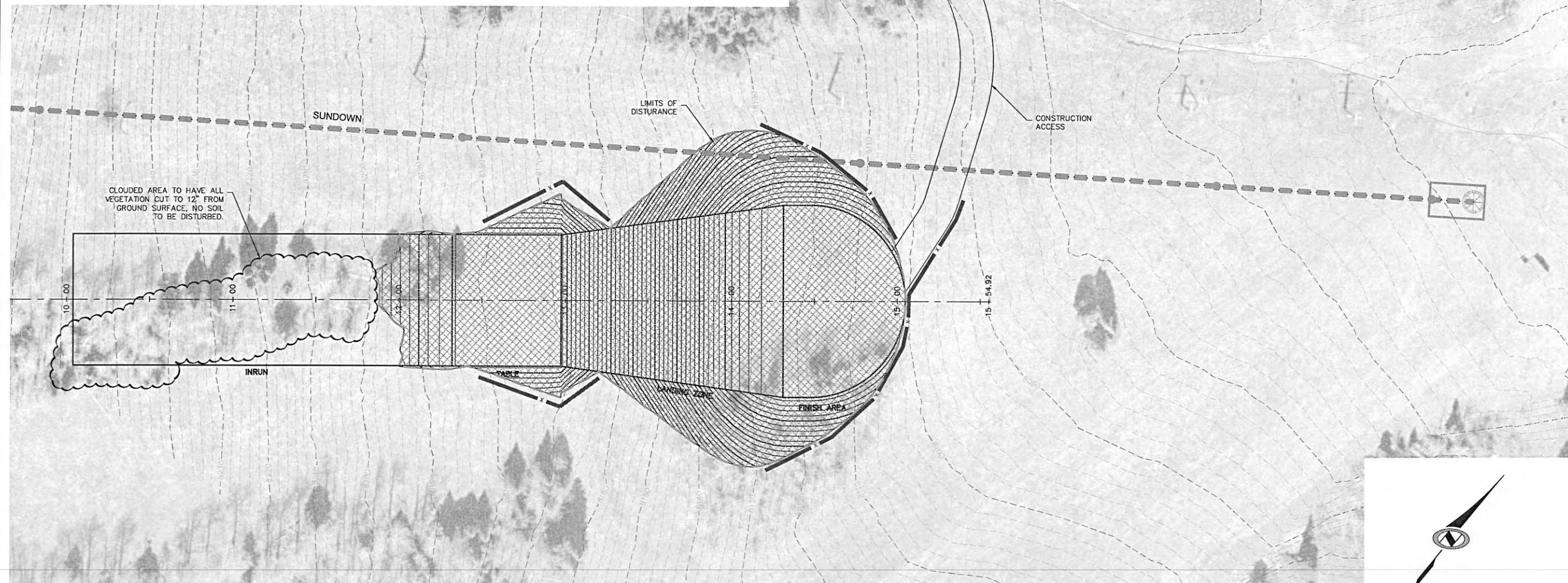

NO.	BY	DATE	REVISIONS

CAUTION
 The engineer preparing these plans will not be responsible for, or liable for, unauthorized changes to or use of these plans. All changes to the plans must be in writing and must be approved by the engineer of these plans.

**POWDER MOUNTAIN
 SUNDOWN SKI JUMP
 EROSION CONTROL PLAN**

DATE SUBMITTED: 11/06/2014

PREPARED FOR: WATTS



MURRAY, UT 84107
 WWW.NV5.COM

6217 SOUTH STATE STREET, SUITE 200
 801743-8900 TEL. 801743-8900 FAX

SHEET NUMBER	2
OF	2 SHEETS
SCALE	VERTICAL: 1" = 30' HORIZONTAL: 1" = 30'
JOB NUMBER	SLB0793

BOWLDEN
 SHEETS

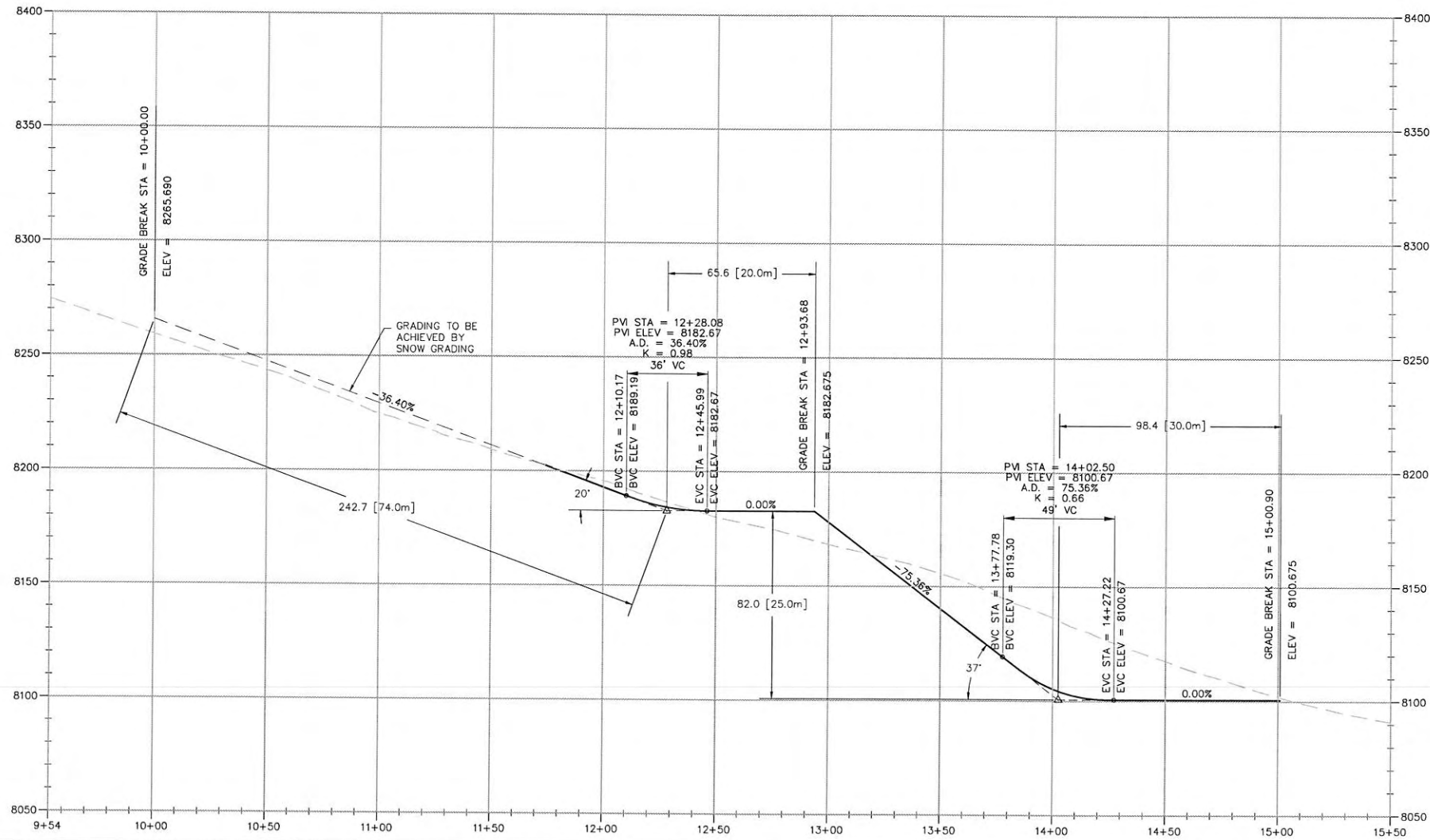
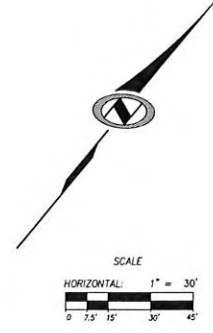
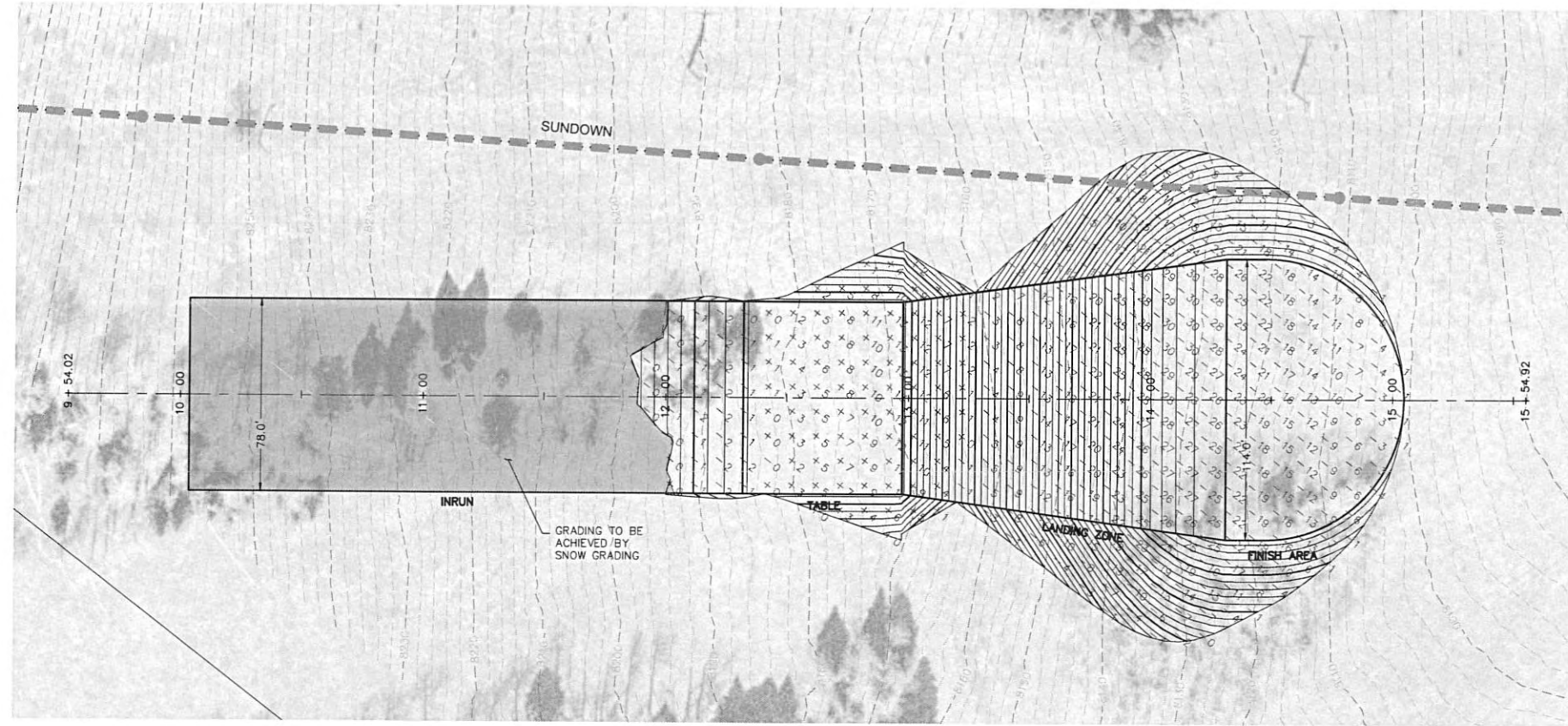

POWDER MOUNTAIN
SUNDOWN SKI JUMP
SITE & GRADING PLAN

DATE SUBMITTED: 11/06/2014

PREPARED FOR: WATTS

NV5
 BELVIDER ENGINEERING

827 SOUTH STATE STREET, SUITE 200
 MURRAY, UT 84007
 801.748.1990 TEL 801.748.0300 FAX
 WWW.NV5.COM

SHEET NUMBER
1
 OF **2** SHEETS

SCALE
 VERTICAL: 1" = 30'
 HORIZONTAL: 1" = 30'

JOB NUMBER
SLB0793

REVISIONS
 NO. BY DATE
 1
 2
 3
 4
 5
 6
 7
 8
 9
 10
 11
 12
 13
 14
 15
 16
 17
 18
 19
 20
 21
 22
 23
 24
 25
 26
 27
 28
 29
 30
 31
 32
 33
 34
 35
 36
 37
 38
 39
 40
 41
 42
 43
 44
 45
 46
 47
 48
 49
 50
 51
 52
 53
 54
 55
 56
 57
 58
 59
 60
 61
 62
 63
 64
 65
 66
 67
 68
 69
 70
 71
 72
 73
 74
 75
 76
 77
 78
 79
 80
 81
 82
 83
 84
 85
 86
 87
 88
 89
 90
 91
 92
 93
 94
 95
 96
 97
 98
 99
 100

The engineer preparing these plans will not be responsible for, or liable for, unauthorized changes to or uses of these plans. All changes to the plans must be in writing and must be approved by the preparer of these plans.