

Date: 2/3/2015

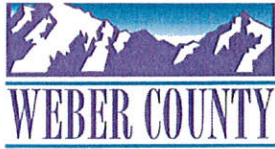

Planning Commission

Land Use Permit

Page 1 of 2

Printed: 2/3/2015

Permit Number: LUP10-2015

Applicant

Name: Lainie Elmer
Address: 2128 E Eastwood Blvd
Phone: 801-393-2335

Owner

Name: Lainie Elmer
Address: 2128 E Eastwood Blvd
Phone: 801-393-2335

Parcel

Parcel Number: 072290007

Zoning: RE-15

Total Parcel Area: 0.49

(*If Zoned S-1, See Specific Height Requirements)

Address: 2128 E Eastwood Blvd
OGDEN, UT 84403

****See Diagram on Back Side for Setbacks**

Section: 23

Township: 5N

Range: 1W

Subdivision: Uintah Highlands

Lot(s): 35

Proposed Structure: Home Occupation (LUP)

Structure Area Used:

Is Structure > 1,000 Sq. Ft.?

*If True, Need Certif. Statement

of Dwelling Units: 1

of Accessory Bldgs: 0

Off-Street Parking Req'd: 2



Permit Checklist:

Public by/Right of Use Road?

> 200 ft. from Paved Road?

No

< 4218 ft. above Sea Level?

No

Wetlands/Flood Zone? No

Culvert Required?

No

If Yes, Culvert Size:

***Any Work in the Right of Way requires an Excavation Permit**

Additional Frontage Req'd.?

No

OR Special Exception?

Case #

Meet Zone Area & Frontage?

True

Hillside Review Req'd.?

No

Case #

Culinary Water District:

Uintah Highlands

Waste Water System:

Uintah Highlands

Comments: This permit is for an in home preschool for 6-8 students ages 3-4 from August through May. Classes will be offered Tuesday and Thursday from 9:00 to 11:00 a.m. and possibly in the afternoon from 12:00 to 2:00 p.m. No sign is anticipated and adequate room for parking and drop off is available. Classes will be held mostly indoors.

Structure Setback Graphic:

Home Occupation

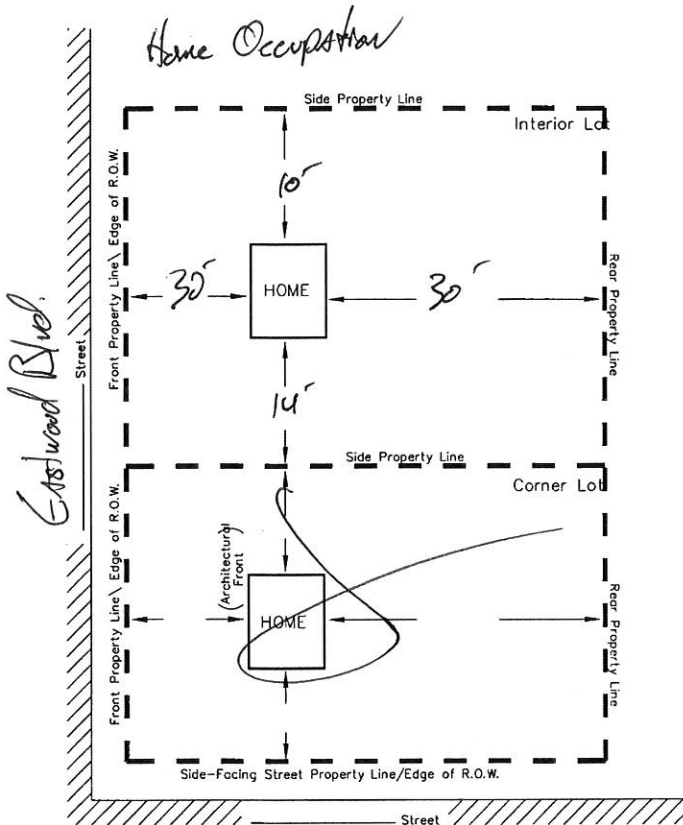

MINIMUM YARD SETBACKS
New Dwelling, Addition, Etc.

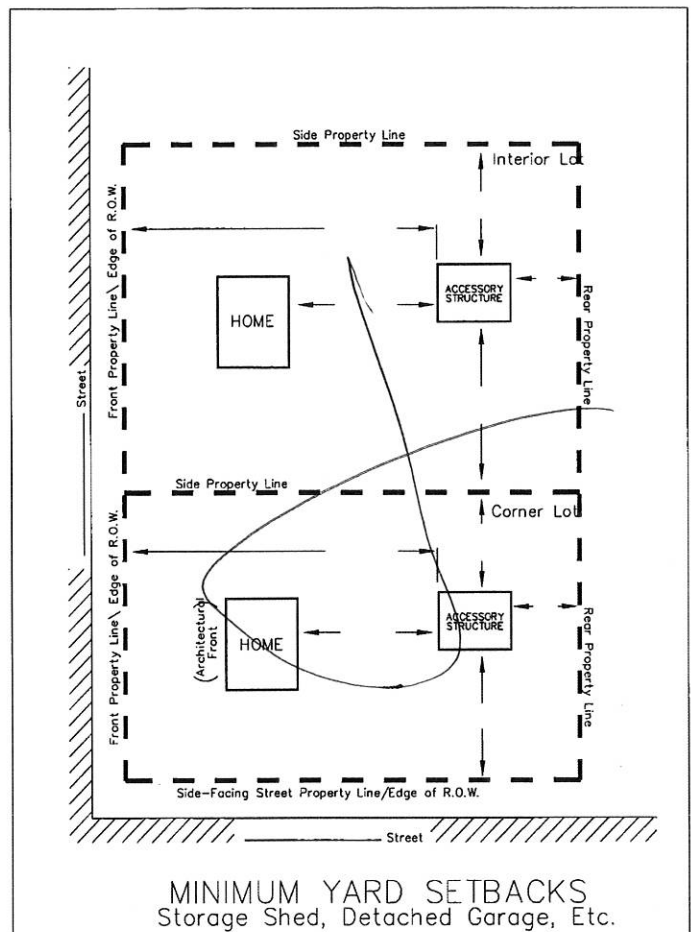

MINIMUM YARD SETBACKS
Storage Shed, Detached Garage, Etc.

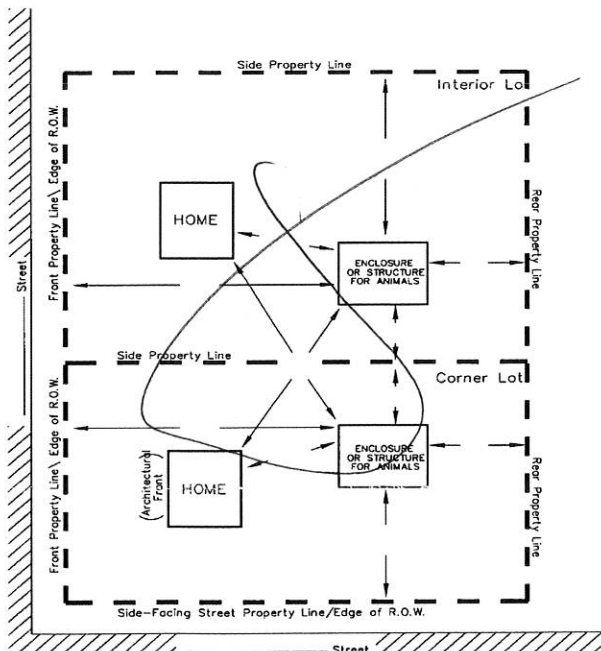

MINIMUM YARD SETBACKS
Barn, Corral, or Stable

NOTICE FOR APPLICANT (Please Read Before Signing)

Proposals for the installation of an individual water supply and for a sanitary waste disposal system (septic tank) for any structure designed for human occupation must be approved by the Weber County Health Department prior to installation.

Planning Dept. Signature of Approval

Date

This permit becomes null and void if use or construction authorized has not commenced within 180 days or if there is a zone change affecting this property. I hereby certify that I have read and examined this application and know the same to be true and correct. All provisions of laws and ordinances governing this land use will be complied with whether specified herein or not. I make this statement under penalty of perjury. I hereby agree to make the requirements as specified on this permit issued to the owner of land as signed below.

Contractor/Owner Signature of Approval Date