

BASIS OF BEARING NOTE:
THE BASIS OF BEARINGS FOR THIS SURVEY WAS ESTABLISHED BY GPS TECHNIQUES, PROJECTED TO THE UTAH COORDINATE SYSTEM 1983 CENTRAL ZONE. ALL BEARINGS SHOWN ARE ON GRID AZIMUTH AND ALL DISTANCES SHOWN ARE AT GROUND. REFER TO THE DRAWING FOR THE SPECIFIC LINE AND MONUMENTS USED.
THE CONVERGENCE ANGLE OF -0° 14' 11.3" WAS CALCULATED AT THE CENTER OF THE TOWER LOCATIONS SHOWN.

BASIS OF GEODETIC COORDINATES:
(1) THE GEODETIC COORDINATES SHOWN HEREON WERE DERIVED FROM THE NATIONAL GEODETIC SURVEY (OPUS) UTILITY VIA STATIC GPS OBSERVATIONS UPON THE PROJECT CONTROL POINT. ALL SUBSEQUENT OBSERVATIONS WERE PROCESSED USING THE MICRO-SURVEY STAR*NET-PRO UTILITY.
(2) HORIZONTAL DATUM: THE NORTH AMERICAN DATUM OF 1983 (NAD83)/(2011)(EPOCH 2010) IS EXPRESSED IN DEGREES (°) MINUTES (') AND SECONDS (") AND ARE SHOWN TO THE 100TH OF A SECOND AND IN DECIMAL DEGREES.
(3) VERTICAL DATUM: THE NORTH AMERICAN VERTICAL DATUM OF 1988 (NAV88)(GEOD 12B) IS EXPRESSED IN U.S. SURVEY FEET AND IN METERS.

UTILITY NOTE:
THE UNDERGROUND UTILITIES SHOWN HAVE BEEN LOCATED FROM SURFACE FIELD OBSERVATIONS. THE SURVEYOR MAKES NO WARRANTIES OR GUARANTEES THAT THE UNDERGROUND UTILITIES SHOWN COMPRISE ALL SUCH UTILITIES IN THE AREA EITHER IN SERVICE OR ABANDONED. THE SURVEYOR DOES NOT WARRANT THE UNDERGROUND UTILITIES SHOWN ARE IN THE EXACT LOCATION INDICATED, ALTHOUGH HE DOES CERTIFY THEY ARE LOCATED AS ACCURATELY AS REASONABLY EXPECTED FROM THE INFORMATION DESCRIBED. THE SURVEYOR HAS NOT PHYSICALLY LOCATED THE UNDERGROUND POSITION OF THE UTILITIES. (POT HOLING TO OBTAIN HORIZONTAL AND VERTICAL POSITIONS AND PIPE SIZES WAS NOT PERFORMED). THE SURVEYOR DID NOT ENTER ANY CONFINED SPACES OR CONTACT DIGNLINE FOR UTILITY MARK OUTS.

DESIGNED FOR:



9656 SOUTH PROSPERITY ROAD
WEST JORDAN, UTAH 84088

PROJECT NAME:

SAL BECKER



Technology Associates Engineering Corporation Inc.

TECHNOLOGY ASSOCIATES

| | |
|---|---|
| <p>UTAH MARKET OFFICE</p> <p>5710 SOUTH GREEN ST. SALT LAKE CITY, UT 84123</p> | <p>CORPORATE OFFICE</p> <p>3115 S. MELROSE DR., # 110 CARLSBAD, CA 92010</p> |
|---|---|

FOX LAND SURVEYS INC

1515 S. Shoshone, Boise, Idaho 83705

www.foxland-surveys.com

Tel 208-342-7957

1414-34-MS

Sheet 1 of 3

SURVEYOR'S NOTE & CERTIFICATION:
THIS "LEASE SITE SURVEY" IS BASED ON AN ACTUAL FIELD SURVEY PERFORMED BY ME OR UNDER MY DIRECTION. IT CORRECTLY DEPICTS EXISTING, READILY VISIBLE IMPROVEMENTS AND ABOVE GROUND UTILITIES. THE BOUNDARY OF THE PARENT PARCEL IS SHOWN FROM RECORD INFORMATION. THIS "LEASE SITE SURVEY" IS NOT A BOUNDARY SURVEY OF THE PARENT PARCEL AND IT WAS DEVELOPED TO SUPPORT THE COMMUNICATIONS FACILITY SHOWN HEREON. RONALD M. HODGE, UTAH PLS 377008

(THESE DRAWINGS AND SURVEYS ARE COPYRIGHT PROTECTED AND THE SOLE PROPERTY OF FOX LAND SURVEYS INC. AND PRODUCED FOR THE USE OF OUR CLIENT. ANY REPRODUCTION OR USE OF THE INFORMATION CONTAINED WITHIN SAID DOCUMENTS IS PROHIBITED WITHOUT THE WRITTEN CONSENT BY FOX LAND SURVEYS INC.)

| REV. | DESCRIPTION | DATE | BY | CHK |
|------|--|----------|-----|-----|
| B | 90% PRELIMINARY FOR CLIENT REVIEW ONLY | 11-04-14 | DSP | TAJ |
| C | 100% FINAL FOR CLIENT USE | 11-04-14 | DSP | TAJ |
| D | REVISED UTILITY EASEMENT | 05-23-16 | DSP | RMH |
| E | REVISED COUNTRY CLUB NAME | 03-25-16 | DSP | RMH |

LEASE SITE SURVEY
SAL BECKER
GENERAL DESCRIPTION OF LESSOR'S PARCEL
PART OF THE EAST 1/2 & PART OF THE SE 1/4
OF THE SW 1/4 OF SECTION 5, T.5 N., R.1 E.
SALT LAKE BASE & MERIDIAN,
WEBER & MORGAN COUNTIES, UTAH.

DESIGNED FOR:

verizon
wireless

9656 SOUTH PROSPERITY ROAD
WEST JORDAN, UTAH 84088

PROJECT NAME:

SAL BECKER



LEASE SITE DESCRIPTION:

A LEASE AREA LYING IN THE NORTHEAST 1/4 OF THE SOUTHEAST 1/4 SECTION 5, TOWNSHIP 5 NORTH, RANGE 1 EAST, SALT LAKE BASE & MERIDIAN, WEBER AND MORGAN COUNTIES, UTAH, BEING MORE PARTICULARLY DESCRIBED AS FOLLOWS:

A. COMMENCING AT THE CORNER COMMON TO SECTIONS 32 AND 33, TOWNSHIP 6 NORTH, RANGE 1 EAST, AND SECTIONS 4 AND 5, TOWNSHIP 5 NORTH, RANGE 1 EAST (TO BE MONUMENTED BY THE WEBER COUNTY SURVEYOR), FROM WHICH THE FOUND BRASS CAP MONUMENT MARKING THE QUARTER CORNER COMMON TO SECTIONS 32 AND 33 BEARS NORTH 01°10'17" EAST, A DISTANCE OF 2670.56 FEET;

B. THENCE SOUTH 19° 43' 27" WEST, A DISTANCE OF 3549.75 FEET TO THE **POINT OF BEGINNING** OF THE LEASE SITE HEREIN DESCRIBED:

1. THENCE SOUTH 69°47'35" EAST, A DISTANCE OF 20.00 FEET TO A SURVEY MONUMENT TO BE SET;
2. THENCE SOUTH 20°12'25" WEST, A DISTANCE OF 20.00 FEET TO A SURVEY MONUMENT TO BE SET IN THE WESTERLY LIMIT OF AN ACCESS EASEMENT, INTERSECTING AT A NON-RADIAL ANGLE IN A CURVE TO THE LEFT;
3. THENCE NORTH 69°47'35" WEST, A DISTANCE OF 20.00 FEET TO A SURVEY MONUMENT TO BE SET;
4. THENCE NORTH 20°12'25" EAST, A DISTANCE OF 20.00 FEET TO THE **POINT OF BEGINNING**.

CONTAINING 400 SQUARE FEET (0.009 ACRES) MORE OR LESS.
ANY MODIFICATION OF THIS DESCRIPTION SHALL RENDER IT VOID.

UTILITY EASEMENT DESCRIPTION:

A 10' WIDE STRIP OF LAND FOR AN EASEMENT LYING IN THE NORTHEAST 1/4 OF THE SOUTHEAST 1/4 SECTION 5, TOWNSHIP 5 NORTH, RANGE 1 EAST, SALT LAKE BASE & MERIDIAN, WEBER AND MORGAN COUNTIES, UTAH, LYING 5.00 FEET LEFT AND RIGHT OF THE FOLLOWING DESCRIBED CENTER LINES:

A. **COMMENCING** AT THE CORNER COMMON TO SECTIONS 32 AND 33, TOWNSHIP 6 NORTH, RANGE 1 EAST, AND SECTIONS 4 AND 5, TOWNSHIP 5 NORTH, RANGE 1 EAST (TO BE MONUMENTED BY THE WEBER COUNTY SURVEYOR), FROM WHICH THE FOUND BRASS CAP MONUMENT MARKING THE QUARTER CORNER COMMON TO SECTIONS 32 AND 33 BEARS NORTH 01°10'17" EAST, A DISTANCE OF 2670.56 FEET;

B.

C. THENCE SOUTH 19° 18' 47" WEST, A DISTANCE OF 3519.94 FEET TO THE SOUTHEAST BOUNDARY OF A LEASE SITE AND THE **POINT OF BEGINNING**;

D. THENCE SOUTH 20°12'25" WEST, A DISTANCE OF 66.74 FEET TO **POINT "A"**;

E. THENCE SOUTH 14° 03' 03" WEST, A DISTANCE OF 78.51 FEET;

F. THENCE SOUTH 64° 00' 22" WEST, A DISTANCE OF 50.34 FEET TO THE **POINT OF TERMINUS**.

TOGETHER WITH:

COMMENCING AT **POINT "A"**;

THENCE NORTH 69°47'35" WEST, A DISTANCE OF 18.84 FEET TO THE **POINT OF TERMINUS**.

THE SIDE LINES OF THE EASEMENT ARE TO BE LENGTHENED OR SHORTENED TO MEET THE LEASE BOUNDARY AT THE BEGINNING AND TO FORM A CLOSED FIGURE, CONTAINING 2,104 SQUARE FEET (0.049 ACRES) MORE OR LESS, ANY MODIFICATION OF THIS DESCRIPTION SHALL RENDER IT VOID.

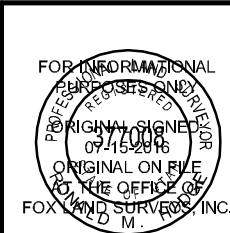

TAEC
Technology Associates Engineering Corporation Inc.
TECHNOLOGY ASSOCIATES
UTAH MARKET OFFICE / CORPORATE OFFICE
5710 SOUTH GREEN ST. / 3115 S. MELROSE DR., # 110
SALT LAKE CITY, UT 84123 / CARLSBAD, CA 92010
FOX LAND SURVEYS INC
1515 S. Shoshone, Boise, Idaho 83705
www.foxland-surveys.com
Tel: 208-342-7957
1414-34-MS
Sheet 2 of 3

ACCESS EASEMENT DESCRIPTION:

A 12 FOOT WIDE STRIP FOR AN ACCESS EASEMENT CROSSING THE NORTHWEST 1/4 OF THE SOUTHWEST 1/4 SECTION 33, AND THE EAST 1/2 OF SECTION 32 IN TOWNSHIP 6 NORTH, RANGE 1 EAST, AND THE EAST 1/2 OF SECTION 5, TOWNSHIP 5 NORTH, RANGE 1 EAST, SALT LAKE BASE & MERIDIAN, WEBER AND MORGAN COUNTIES, UTAH, LYING 6.00 FEET LEFT AND RIGHT OF THE FOLLOWING DESCRIBED CENTER LINE:

A.COMMENCING AT THE CORNER COMMON TO SECTIONS 32 AND 33, TOWNSHIP 6 NORTH, RANGE 1 EAST, AND SECTIONS 4 AND 5, TOWNSHIP 5 NORTH, RANGE 1 EAST (TO BE MONUMENTED BY THE WEBER COUNTY SURVEYOR), FROM WHICH THE FOUND BRASS CAP MONUMENT MARKING THE QUARTER CORNER COMMON TO SECTIONS 32 AND 33 BEARS NORTH 01°10'17" EAST, A DISTANCE OF 2670.56 FEET;

B.THENCE NORTH 14° 50' 30" EAST, A DISTANCE OF 2219.16 FEET TO THE SOUTHWEST RIGHT-OF-WAY OF SNOWBASIN ROAD, THE **TRUE POINT OF BEGINNING** OF THE CENTER LINE OF THE EASEMENT HEREIN DESCRIBED, FROM WHICH THE QUARTER CORNER COMMON TO SECTIONS 32 AND 33 BEARS NORTH 44° 23' 28" WEST, A DISTANCE OF 734.52 FEET;

C.THENCE ALONG SAID CENTER LINE THE FOLLOWING COURSES AND DISTANCES:

1. SOUTH 48°07'54" WEST, A DISTANCE OF 155.08 FEET TO THE BEGINNING OF A CURVE TO THE RIGHT;
2. ALONG SAID CURVE RIGHT HAVING A LENGTH OF 332.96 FEET, A RADIUS OF 420.00 FEET, A CENTRAL ANGLE OF 45°25'17", TANGENTS OF 175.78 FEET AND A LONG CHORD WHICH BEARS SOUTH 70°50'32" WEST, A DISTANCE OF 324.31 FEET TO A POINT OF REVERSE CURVATURE;
3. ALONG A CURVE LEFT HAVING A LENGTH OF 154.48 FEET, A RADIUS OF 150.00 FEET, A CENTRAL ANGLE OF 59°00'22", TANGENTS OF 84.88 FEET AND A LONG CHORD WHICH BEARS SOUTH 64°03'00" WEST, A DISTANCE OF 147.74 FEET TO A POINT OF TANGENCY;
4. SOUTH 34°32'49" WEST, A DISTANCE OF 173.43 FEET TO THE BEGINNING OF A CURVE TO THE RIGHT;
5. ALONG SAID CURVE RIGHT HAVING A LENGTH OF 148.02 FEET, A RADIUS OF 444.44 FEET, A CENTRAL ANGLE OF 19°04'55", TANGENTS OF 74.70 FEET AND A LONG CHORD WHICH BEARS SOUTH 44°05'16" WEST, A DISTANCE OF 147.33 FEET TO A POINT OF TANGENCY;
6. SOUTH 53°37'44" WEST, A DISTANCE OF 172.85 FEET TO THE BEGINNING OF A CURVE TO THE RIGHT;
7. ALONG SAID CURVE RIGHT HAVING A LENGTH OF 141.28 FEET, A RADIUS OF 1575.00 FEET, A CENTRAL ANGLE OF 5°08'22", TANGENTS OF 70.69 FEET AND A LONG CHORD WHICH BEARS SOUTH 56°11'55" WEST, A DISTANCE OF 141.23 FEET TO A POINT OF REVERSE CURVATURE;
8. ALONG A CURVE LEFT HAVING A LENGTH OF 79.37 FEET, A RADIUS OF 577.51 FEET, A CENTRAL ANGLE OF 7°52'27", TANGENTS OF 39.75 FEET AND A LONG CHORD WHICH BEARS SOUTH 54°49'52" WEST, A DISTANCE OF 79.31 FEET TO A POINT OF REVERSE CURVATURE;
9. ALONG A CURVE RIGHT HAVING A LENGTH OF 72.71 FEET, A RADIUS OF 128.00 FEET, A CENTRAL ANGLE OF 32°32'49", TANGENTS OF 37.37 FEET AND A LONG CHORD WHICH BEARS SOUTH 67°10'03" WEST, A DISTANCE OF 71.74 FEET TO A POINT OF TANGENCY;
10. SOUTH 83°26'27" WEST, A DISTANCE OF 97.16 FEET TO THE BEGINNING OF A CURVE TO THE RIGHT;
11. ALONG SAID CURVE RIGHT HAVING A LENGTH OF 100.30 FEET, A RADIUS OF 74.96 FEET, A CENTRAL ANGLE OF 76°39'46", TANGENTS OF 59.27 FEET AND A LONG CHORD WHICH BEARS NORTH 58°13'40" WEST, A DISTANCE OF 92.98 FEET TO A POINT OF TANGENCY;
12. NORTH 19°53'47" WEST, A DISTANCE OF 34.15 FEET TO THE BEGINNING OF A CURVE TO THE LEFT;
13. ALONG SAID CURVE LEFT HAVING A LENGTH OF 146.94 FEET, A RADIUS OF 206.39 FEET, A CENTRAL ANGLE OF 40°47'28", TANGENTS OF 76.74 FEET AND A LONG CHORD WHICH BEARS NORTH 40°17'31" WEST, A DISTANCE OF 143.85 FEET TO A POINT OF TANGENCY;
14. NORTH 60°41'15" WEST, A DISTANCE OF 60.00 FEET TO THE BEGINNING OF A CURVE TO THE RIGHT;
15. ALONG SAID CURVE RIGHT HAVING A LENGTH OF 84.17 FEET, A RADIUS OF 670.57 FEET, A CENTRAL ANGLE OF 7°11'29", TANGENTS OF 42.14 FEET AND A LONG CHORD WHICH BEARS NORTH 57°05'31" WEST, A DISTANCE OF 84.11 FEET TO A POINT OF REVERSE CURVATURE;
16. ALONG A CURVE LEFT HAVING A LENGTH OF 37.58 FEET, A RADIUS OF 50.00 FEET, A CENTRAL ANGLE OF 43°03'43", TANGENTS OF 19.73 FEET AND A LONG CHORD WHICH BEARS NORTH 75°01'38" WEST, A DISTANCE OF 36.70 FEET TO A POINT OF COMPOUND CURVATURE;
17. ALONG A CURVE LEFT HAVING A LENGTH OF 63.65 FEET, A RADIUS OF 34.60 FEET, A CENTRAL ANGLE OF 105°23'37", TANGENTS OF 45.41 FEET AND A LONG CHORD WHICH BEARS SOUTH 30°44'42" WEST, A DISTANCE OF 55.04 FEET TO A POINT OF TANGENCY;
18. SOUTH 21°53'46" EAST, A DISTANCE OF 24.22 FEET TO THE BEGINNING OF A CURVE TO THE RIGHT;
19. ALONG SAID CURVE RIGHT HAVING A LENGTH OF 188.07 FEET, A RADIUS OF 273.21 FEET, A CENTRAL ANGLE OF 39°26'26", TANGENTS OF 97.93 FEET AND A LONG CHORD WHICH BEARS SOUTH 02°10'33" EAST, A DISTANCE OF 184.38 FEET TO A POINT OF REVERSE CURVATURE;
20. ALONG A CURVE LEFT HAVING A LENGTH OF 147.43 FEET, A RADIUS OF 200.00 FEET, A CENTRAL ANGLE OF 42°14'13", TANGENTS OF 77.25 FEET AND A LONG CHORD WHICH BEARS SOUTH 03°34'26" EAST, A DISTANCE OF 144.12 FEET TO A POINT OF REVERSE CURVATURE;
21. ALONG A CURVE RIGHT HAVING A LENGTH OF 179.71 FEET, A RADIUS OF 430.00 FEET, A CENTRAL ANGLE OF 23°56'43", TANGENTS OF 91.18 FEET AND A LONG CHORD WHICH BEARS SOUTH 12°43'11" EAST, A DISTANCE OF 178.40 FEET TO A POINT OF REVERSE CURVATURE;
22. ALONG A CURVE LEFT HAVING A LENGTH OF 104.17 FEET, A RADIUS OF 666.59 FEET, A CENTRAL ANGLE OF 8°57'13", TANGENTS OF 52.19 FEET AND A LONG CHORD WHICH BEARS SOUTH 05°13'26" EAST, A DISTANCE OF 104.06 FEET TO A POINT OF COMPOUND CURVATURE;
23. ALONG A CURVE LEFT HAVING A LENGTH OF 128.39 FEET, A RADIUS OF 82.00 FEET, A CENTRAL ANGLE OF 89°42'29", TANGENTS OF 81.58 FEET AND A LONG CHORD WHICH BEARS SOUTH 54°33'18" EAST, A DISTANCE OF 115.67 FEET TO A POINT OF REVERSE CURVATURE;

24. ALONG A CURVE RIGHT HAVING A LENGTH OF 150.43 FEET, A RADIUS OF 1308.88 FEET, A CENTRAL ANGLE OF 6°35'06", TANGENTS OF 75.30 FEET AND A LONG CHORD WHICH BEARS NORTH 83°53'01" EAST, A DISTANCE OF 150.34 FEET TO A POINT OF REVERSE CURVATURE;
25. ALONG A CURVE LEFT HAVING A LENGTH OF 130.69 FEET, A RADIUS OF 275.00 FEET, A CENTRAL ANGLE OF 27°13'41", TANGENTS OF 66.60 FEET AND A LONG CHORD WHICH BEARS SOUTH 73°33'43" EAST, A DISTANCE OF 129.46 FEET TO A POINT OF TANGENCY;
26. NORTH 59°56'53" EAST, A DISTANCE OF 89.91 FEET TO THE BEGINNING OF A CURVE TO THE RIGHT;
27. ALONG SAID CURVE RIGHT HAVING A LENGTH OF 95.56 FEET, A RADIUS OF 49.00 FEET, A CENTRAL ANGLE OF 111°44'10", TANGENTS OF 72.29 FEET AND A LONG CHORD WHICH BEARS SOUTH 64°11'02" EAST, A DISTANCE OF 81.12 FEET TO A POINT OF TANGENCY;
28. SOUTH 08°18'57" EAST, A DISTANCE OF 55.50 FEET TO THE BEGINNING OF A CURVE TO THE LEFT;
29. ALONG SAID CURVE LEFT HAVING A LENGTH OF 215.59 FEET, A RADIUS OF 996.40 FEET, A CENTRAL ANGLE OF 12°23'50", TANGENTS OF 108.22 FEET AND A LONG CHORD WHICH BEARS SOUTH 14°30'52" EAST, A DISTANCE OF 215.17 FEET TO A POINT OF REVERSE CURVATURE;
30. ALONG A CURVE RIGHT HAVING A LENGTH OF 140.44 FEET, A RADIUS OF 247.00 FEET, A CENTRAL ANGLE OF 32°34'41", TANGENTS OF 72.18 FEET AND A LONG CHORD WHICH BEARS SOUTH 04°25'26" EAST, A DISTANCE OF 138.56 FEET TO A POINT OF TANGENCY;
31. SOUTH 11°51'54" WEST, A DISTANCE OF 270.60 FEET TO THE BEGINNING OF A CURVE TO THE LEFT;
32. ALONG A CURVE LEFT HAVING A LENGTH OF 161.64 FEET, A RADIUS OF 356.38 FEET, A CENTRAL ANGLE OF 25°59'17", TANGENTS OF 82.24 FEET AND A LONG CHORD WHICH BEARS SOUTH 01°07'44" EAST, A DISTANCE OF 160.26 FEET TO A POINT OF COMPOUND CURVATURE;
33. ALONG A CURVE LEFT HAVING A LENGTH OF 127.72 FEET, A RADIUS OF 51.00 FEET, A CENTRAL ANGLE OF 143°29'06", TANGENTS OF 154.59 FEET AND A LONG CHORD WHICH BEARS SOUTH 85°51'56" EAST, A DISTANCE OF 96.87 FEET TO A POINT OF REVERSE CURVATURE;
34. ALONG A CURVE RIGHT HAVING A LENGTH OF 141.99 FEET, A RADIUS OF 349.72 FEET, A CENTRAL ANGLE OF 23°15'45", TANGENTS OF 71.99 FEET AND A LONG CHORD WHICH BEARS NORTH 34°01'24" EAST, A DISTANCE OF 141.02 FEET TO A POINT OF COMPOUND CURVATURE;
35. ALONG A CURVE RIGHT HAVING A LENGTH OF 146.69 FEET, A RADIUS OF 52.20 FEET, A CENTRAL ANGLE OF 161°00'27", TANGENTS OF 312.06 FEET AND A LONG CHORD WHICH BEARS SOUTH 53°50'30" EAST, A DISTANCE OF 102.97 FEET TO A POINT OF TANGENCY;
36. SOUTH 26°39'43" WEST, A DISTANCE OF 87.80 FEET TO THE BEGINNING OF A CURVE TO THE LEFT;
37. ALONG A CURVE LEFT HAVING A LENGTH OF 173.68 FEET, A RADIUS OF 728.90 FEET, A CENTRAL ANGLE OF 13°39'07", TANGENTS OF 87.25 FEET AND A LONG CHORD WHICH BEARS SOUTH 19°50'10" WEST, A DISTANCE OF 173.26 FEET TO A POINT OF TANGENCY;
38. SOUTH 13°00'37" WEST, A DISTANCE OF 70.67 FEET TO THE BEGINNING OF A CURVE TO THE LEFT;
39. ALONG SAID CURVE LEFT HAVING A LENGTH OF 179.02 FEET, A RADIUS OF 365.00 FEET, A CENTRAL ANGLE OF 28°06'07", TANGENTS OF 91.35 FEET AND A LONG CHORD WHICH BEARS SOUTH 01°02'27" EAST, A DISTANCE OF 177.23 FEET TO A POINT OF REVERSE CURVATURE;
40. ALONG A CURVE RIGHT HAVING A LENGTH OF 94.93 FEET, A RADIUS OF 169.00 FEET, A CENTRAL ANGLE OF 32°10'57", TANGENTS OF 48.75 FEET AND A LONG CHORD WHICH BEARS SOUTH 00°59'58" WEST, A DISTANCE OF 93.68 FEET TO A POINT OF COMPOUND CURVATURE;
41. ALONG A CURVE RIGHT HAVING A LENGTH OF 88.66 FEET, A RADIUS OF 43.73 FEET, A CENTRAL ANGLE OF 116°10'15", TANGENTS OF 70.21 FEET AND A LONG CHORD WHICH BEARS SOUTH 74°59'42" WEST, A DISTANCE OF 74.24 FEET TO A POINT OF TANGENCY;
42. NORTH 46°55'10" WEST, A DISTANCE OF 30.48 FEET TO THE BEGINNING OF A CURVE TO THE LEFT;
43. ALONG SAID CURVE LEFT HAVING A LENGTH OF 138.94 FEET, A RADIUS OF 152.52 FEET, A CENTRAL ANGLE OF 52°11'44", TANGENTS OF 74.71 FEET AND A LONG CHORD WHICH BEARS NORTH 73°01'02" WEST, A DISTANCE OF 134.19 FEET TO A POINT OF TANGENCY;
44. SOUTH 80°53'06" WEST, A DISTANCE OF 72.37 FEET TO THE BEGINNING OF A CURVE TO THE RIGHT;
45. ALONG SAID CURVE RIGHT HAVING A LENGTH OF 103.76 FEET, A RADIUS OF 96.61 FEET, A CENTRAL ANGLE OF 61°32'03", TANGENTS OF 57.52 FEET AND A LONG CHORD WHICH BEARS NORTH 68°20'52" WEST, A DISTANCE OF 98.84 FEET TO A POINT OF REVERSE CURVATURE;
46. ALONG A CURVE LEFT HAVING A LENGTH OF 89.52 FEET, A RADIUS OF 300.00 FEET, A CENTRAL ANGLE OF 17°05'49", TANGENTS OF 45.09 FEET AND A LONG CHORD WHICH BEARS NORTH 46°07'45" WEST, A DISTANCE OF 89.19 FEET TO A POINT OF REVERSE CURVATURE;
47. ALONG A CURVE RIGHT HAVING A LENGTH OF 181.43 FEET, A RADIUS OF 371.80 FEET, A CENTRAL ANGLE OF 27°57'33", TANGENTS OF 92.56 FEET AND A LONG CHORD WHICH BEARS NORTH 40°41'53" WEST, A DISTANCE OF 179.64 FEET TO A POINT OF TANGENCY;
48. NORTH 26°43'06" WEST, A DISTANCE OF 144.92 FEET TO THE BEGINNING OF A CURVE TO THE LEFT;
49. ALONG SAID CURVE LEFT HAVING A LENGTH OF 58.80 FEET, A RADIUS OF 60.00 FEET, A CENTRAL ANGLE OF 56°09'17", TANGENTS OF 32.01 FEET AND A LONG CHORD WHICH BEARS NORTH 54°47'45" WEST, A DISTANCE OF 56.48 FEET TO A POINT OF COMPOUND CURVATURE;
50. ALONG A CURVE LEFT HAVING A LENGTH OF 58.14 FEET, A RADIUS OF 22.19 FEET, A CENTRAL ANGLE OF 150°05'45", TANGENTS OF 83.11 FEET AND A LONG CHORD WHICH BEARS SOUTH 21°49'01" WEST, A DISTANCE OF 42.88 FEET TO A POINT OF TANGENCY;
51. SOUTH 53°13'52" EAST, A DISTANCE OF 25.82 FEET TO THE BEGINNING OF A CURVE TO THE RIGHT;

52. ALONG SAID CURVE RIGHT HAVING A LENGTH OF 59.03 FEET, A RADIUS OF 78.62 FEET, A CENTRAL ANGLE OF 42°51'27", TANGENTS OF 30.97 FEET AND A LONG CHORD WHICH BEARS SOUTH 31°48'09" EAST, A DISTANCE OF 57.66 FEET TO A POINT OF TANGENCY;
53. SOUTH 10°22'26" EAST, A DISTANCE OF 38.12 FEET TO THE BEGINNING OF A CURVE TO THE LEFT;
54. ALONG SAID CURVE LEFT HAVING A LENGTH OF 161.05 FEET, A RADIUS OF 446.09 FEET, A CENTRAL ANGLE OF 20°41'08", TANGENTS OF 81.41 FEET AND A LONG CHORD WHICH BEARS SOUTH 20°43'00" EAST, A DISTANCE OF 160.18 FEET TO A POINT OF REVERSE CURVATURE;
55. ALONG A CURVE RIGHT HAVING A LENGTH OF 205.70 FEET, A RADIUS OF 275.00 FEET, A CENTRAL ANGLE OF 42°51'29", TANGENTS OF 107.93 FEET AND A LONG CHORD WHICH BEARS SOUTH 09°37'50" EAST, A DISTANCE OF 200.94 FEET TO A POINT OF TANGENCY;
56. SOUTH 11°47'55" WEST, A DISTANCE OF 67.06 FEET TO THE BEGINNING OF A CURVE TO THE RIGHT;
57. ALONG SAID CURVE RIGHT HAVING A LENGTH OF 305.14 FEET, A RADIUS OF 1892.96 FEET, A CENTRAL ANGLE OF 9°14'10", TANGENTS OF 152.90 FEET AND A LONG CHORD WHICH BEARS SOUTH 16°24'59" WEST, A DISTANCE OF 304.81 FEET TO A POINT OF TANGENCY;
58. SOUTH 21°02'04" WEST, A DISTANCE OF 105.84 FEET TO THE BEGINNING OF A CURVE TO THE LEFT;
59. ALONG SAID CURVE LEFT HAVING A LENGTH OF 254.37 FEET, A RADIUS OF 1776.77 FEET, A CENTRAL ANGLE OF 8°12'10", TANGENTS OF 127.40 FEET AND A LONG CHORD WHICH BEARS SOUTH 16°55'59" WEST, A DISTANCE OF 254.16 FEET TO A POINT OF REVERSE CURVATURE;
60. ALONG A CURVE RIGHT HAVING A LENGTH OF 129.11 FEET, A RADIUS OF 252.00 FEET, A CENTRAL ANGLE OF 29°21'15", TANGENTS OF 66.00 FEET AND A LONG CHORD WHICH BEARS SOUTH 27°30'31" WEST, A DISTANCE OF 127.70 FEET TO A POINT OF REVERSE CURVATURE;
61. ALONG A CURVE LEFT HAVING A LENGTH OF 358.18 FEET, A RADIUS OF 863.54 FEET, A CENTRAL ANGLE OF 23°45'55", TANGENTS OF 181.70 FEET AND A LONG CHORD WHICH BEARS SOUTH 30°18'11" WEST, A DISTANCE OF 355.62 FEET TO A POINT OF TANGENCY;
62. SOUTH 18°25'14" WEST, A DISTANCE OF 174.86 FEET TO THE BEGINNING OF A CURVE TO THE RIGHT;
63. ALONG SAID CURVE RIGHT HAVING A LENGTH OF 244.71 FEET, A RADIUS OF 524.31 FEET, A CENTRAL ANGLE OF 26°44'32", TANGENTS OF 124.63 FEET AND A LONG CHORD WHICH BEARS SOUTH 31°47'30" WEST, A DISTANCE OF 242.50 FEET TO A POINT OF REVERSE CURVATURE;
64. ALONG A CURVE LEFT HAVING A LENGTH OF 115.23 FEET, A RADIUS OF 490.00 FEET, A CENTRAL ANGLE OF 13°28'28", TANGENTS OF 57.88 FEET AND A LONG CHORD WHICH BEARS SOUTH 38°25'32" WEST, A DISTANCE OF 114.97 FEET TO A POINT OF REVERSE CURVATURE;
65. ALONG A CURVE RIGHT HAVING A LENGTH OF 94.56 FEET, A RADIUS OF 555.38 FEET, A CENTRAL ANGLE OF 9°45'19", TANGENTS OF 47.39 FEET AND A LONG CHORD WHICH BEARS SOUTH 36°33'57" WEST, A DISTANCE OF 94.45 FEET TO A POINT OF REVERSE CURVATURE;
66. ALONG A CURVE LEFT HAVING A LENGTH OF 65.68 FEET, A RADIUS OF 74.00 FEET, A CENTRAL ANGLE OF 50°51'12", TANGENTS OF 35.18 FEET AND A LONG CHORD WHICH BEARS SOUTH 16°01'01" WEST, A DISTANCE OF 63.54 FEET TO A POINT OF TANGENCY;
67. SOUTH 09°24'35" EAST, A DISTANCE OF 71.31 FEET TO THE BEGINNING OF A CURVE TO THE LEFT;
68. ALONG SAID CURVE LEFT HAVING A LENGTH OF 135.74 FEET, A RADIUS OF 110.39 FEET, A CENTRAL ANGLE OF 70°27'04", TANGENTS OF 77.95 FEET AND A LONG CHORD WHICH BEARS SOUTH 44°38'07" EAST, A DISTANCE OF 127.35 FEET TO A POINT OF TANGENCY;
69. SOUTH 79°51'39" EAST, A DISTANCE OF 65.99 FEET TO THE BEGINNING OF A CURVE TO THE LEFT;
70. ALONG SAID CURVE LEFT HAVING A LENGTH OF 125.21 FEET, A RADIUS OF 408.11 FEET, A CENTRAL ANGLE OF 17°34'43", TANGENTS OF 63.10 FEET AND A LONG CHORD WHICH BEARS SOUTH 88°39'01" EAST, A DISTANCE OF 124.72 FEET TO A POINT OF TANGENCY;
71. NORTH 82°33'38" EAST, A DISTANCE OF 47.40 FEET TO THE BEGINNING OF A CURVE TO THE RIGHT;
72. ALONG SAID CURVE RIGHT HAVING A LENGTH OF 113.67 FEET, A RADIUS OF 623.22 FEET, A CENTRAL ANGLE OF 10°27'00", TANGENTS OF 56.99 FEET AND A LONG CHORD WHICH BEARS NORTH 87°47'08" EAST, A DISTANCE OF 113.51 FEET TO A POINT OF REVERSE CURVATURE;
73. ALONG A CURVE LEFT HAVING A LENGTH OF 166.34 FEET, A RADIUS OF 137.00 FEET, A CENTRAL ANGLE OF 69°34'05", TANGENTS OF 95.16 FEET AND A LONG CHORD WHICH BEARS NORTH 58°13'35" EAST, A DISTANCE OF 156.31 FEET TO A POINT OF TANGENCY;
74. NORTH 23°26'33" EAST, A DISTANCE OF 102.81 FEET TO THE BEGINNING OF A CURVE TO THE RIGHT;
75. ALONG SAID CURVE RIGHT HAVING A LENGTH OF 100.70 FEET, A RADIUS OF 171.00 FEET, A CENTRAL ANGLE OF 33°41'31", TANGENTS OF 51.86 FEET AND A LONG CHORD WHICH BEARS NORTH 40°18'49" EAST, A DISTANCE OF 99.25 FEET TO A POINT OF TANGENCY;
76. NORTH 57°11'04" EAST, A DISTANCE OF 194.87 FEET TO THE BEGINNING OF A CURVE TO THE RIGHT;
77. ALONG SAID CURVE RIGHT HAVING A LENGTH OF 66.26 FEET, A RADIUS OF 223.40 FEET, A CENTRAL ANGLE OF 16°59'34", TANGENTS OF 33.37 FEET AND A LONG CHORD WHICH BEARS NORTH 65°40'51" EAST, A DISTANCE OF 66.01 FEET TO A POINT OF COMPOUND CURVATURE;
78. ALONG A CURVE RIGHT HAVING A LENGTH OF 75.32 FEET, A RADIUS OF 34.00 FEET, A CENTRAL ANGLE OF 126°55'15", TANGENTS OF 68.08 FEET AND A LONG CHORD WHICH BEARS SOUTH 42°21'44" EAST, A DISTANCE OF 60.83 FEET TO A POINT OF REVERSE CURVATURE;
79. ALONG A CURVE LEFT HAVING A LENGTH OF 260.59 FEET, A RADIUS OF 3519.18 FEET, A CENTRAL ANGLE OF 4°14'33", TANGENTS OF 130.35 FEET AND A LONG CHORD WHICH BEARS SOUTH 18°58'36" WEST, A DISTANCE OF 260.53 FEET TO A POINT OF COMPOUND CURVATURE;

80. ALONG A CURVE LEFT HAVING A LENGTH OF 117.13 FEET, A RADIUS OF 2030.00 FEET, A CENTRAL ANGLE OF 3°18'21", TANGENTS OF 58.58 FEET AND A LONG CHORD WHICH BEARS SOUTH 15°12'09" WEST, A DISTANCE OF 117.11 FEET TO A POINT OF REVERSE CURVATURE;

81. ALONG A CURVE RIGHT HAVING A LENGTH OF 183.81 FEET, A RADIUS OF 470.00 FEET, A CENTRAL ANGLE OF 22°24'28", TANGENTS OF 93.10 FEET AND A LONG CHORD WHICH BEARS SOUTH 24°45'12" WEST, A DISTANCE OF 182.64 FEET TO A POINT OF REVERSE CURVATURE;

82. ALONG A CURVE LEFT HAVING A LENGTH OF 147.61 FEET, A RADIUS OF 148.00 FEET, A CENTRAL ANGLE OF 57°08'43", TANGENTS OF 80.60 FEET AND A LONG CHORD WHICH BEARS SOUTH 07°23'05" WEST, A DISTANCE OF 141.57 FEET TO A POINT OF TANGENCY;

83. SOUTH 21°11'16" EAST, A DISTANCE OF 44.83 FEET TO THE BEGINNING OF A CURVE TO THE LEFT;

84. ALONG SAID CURVE LEFT HAVING A LENGTH OF 89.63 FEET, A RADIUS OF 265.00 FEET, A CENTRAL ANGLE OF 19°22'48", TANGENTS OF 45.25 FEET AND A LONG CHORD WHICH BEARS SOUTH 11°29'52" EAST, A DISTANCE OF 89.21 FEET TO A POINT OF REVERSE CURVATURE;

85. ALONG A CURVE RIGHT HAVING A LENGTH OF 76.34 FEET, A RADIUS OF 504.44 FEET, A CENTRAL ANGLE OF 8°40'17", TANGENTS OF 38.25 FEET AND A LONG CHORD WHICH BEARS SOUTH 06°08'37" EAST, A DISTANCE OF 76.27 FEET TO A POINT OF TANGENCY;

86. SOUTH 10°28'46" EAST, A DISTANCE OF 31.53 FEET TO THE BEGINNING OF A CURVE TO THE RIGHT;

87. ALONG SAID CURVE RIGHT HAVING A LENGTH OF 26.50 FEET, A RADIUS OF 210.37 FEET, A CENTRAL ANGLE OF 7°13'04", TANGENTS OF 13.27 FEET AND A LONG CHORD WHICH BEARS SOUTH 06°52'13" WEST, A DISTANCE OF 26.48 FEET TO A POINT OF COMPOUND CURVATURE;

88. ALONG A CURVE RIGHT HAVING A LENGTH OF 58.83 FEET, A RADIUS OF 22.50 FEET, A CENTRAL ANGLE OF 149°47'51", TANGENTS OF 83.38 FEET AND A LONG CHORD WHICH BEARS SOUTH 71°38'14" WEST, A DISTANCE OF 43.45 FEET TO A POINT OF COMPOUND CURVATURE;

89. ALONG A CURVE RIGHT HAVING A LENGTH OF 28.48 FEET, A RADIUS OF 869.28 FEET, A CENTRAL ANGLE OF 1°52'37", TANGENTS OF 14.24 FEET AND A LONG CHORD WHICH BEARS NORTH 32°31'31" WEST, A DISTANCE OF 28.48 FEET TO A POINT OF TANGENCY;

90. NORTH 31°35'13" WEST, A DISTANCE OF 87.76 FEET TO THE BEGINNING OF A CURVE TO THE LEFT;

91. ALONG SAID CURVE LEFT HAVING A LENGTH OF 51.72 FEET, A RADIUS OF 30.00 FEET, A CENTRAL ANGLE OF 98°47'09", TANGENTS OF 34.99 FEET AND A LONG CHORD WHICH BEARS NORTH 80°58'47" WEST, A DISTANCE OF 45.55 FEET TO A POINT OF COMPOUND CURVATURE;

92. ALONG A CURVE LEFT HAVING A LENGTH OF 28.79 FEET, A RADIUS OF 50.00 FEET, A CENTRAL ANGLE OF 32°59'18", TANGENTS OF 14.81 FEET AND A LONG CHORD WHICH BEARS SOUTH 33°07'59" WEST, A DISTANCE OF 28.39 FEET TO A POINT OF COMPOUND CURVATURE;

93. ALONG A CURVE LEFT HAVING A LENGTH OF 169.21 FEET, A RADIUS OF 889.55 FEET, A CENTRAL ANGLE OF 10°53'56", TANGENTS OF 84.86 FEET AND A LONG CHORD WHICH BEARS SOUTH 11°11'23" WEST, A DISTANCE OF 168.96 FEET TO A POINT OF TANGENCY;

94. SOUTH 05°44'25" WEST, A DISTANCE OF 22.85 FEET TO THE BEGINNING OF A CURVE TO THE RIGHT;

95. ALONG SAID CURVE RIGHT HAVING A LENGTH OF 197.60 FEET, A RADIUS OF 310.75 FEET, A CENTRAL ANGLE OF 36°26'01", TANGENTS OF 102.27 FEET AND A LONG CHORD WHICH BEARS SOUTH 23°57'25" WEST, A DISTANCE OF 194.29 FEET TO A POINT OF TANGENCY;

96. SOUTH 42°10'25" WEST, A DISTANCE OF 58.82 FEET TO THE BEGINNING OF A CURVE TO THE LEFT;

97. ALONG SAID CURVE LEFT HAVING A LENGTH OF 100.17 FEET, A RADIUS OF 273.75 FEET, A CENTRAL ANGLE OF 20°57'54", TANGENTS OF 50.65 FEET AND A LONG CHORD WHICH BEARS SOUTH 31°41'28" WEST, A DISTANCE OF 99.61 FEET TO THE EASTERLY PROJECTION OF THE SOUTHERLY BOUNDARY OF A LEASE SITE, THE **POINT OF TERMINUS** OF THE CENTER LINE OF THE EASEMENT, FROM WHICH THE CORNER COMMON TO SECTIONS 32 AND 33, TOWNSHIP 6 NORTH, RANGE 1 EAST, AND SECTIONS 4 AND 5, TOWNSHIP 5 NORTH, RANGE 1 EAST (TO BE MONUMENTED BY THE WEBER COUNTY SURVEYOR) BEARS NORTH 19°18'58" EAST, A DISTANCE OF 3570.06 FEET.

THE SIDELINES OF THE EASEMENT ARE TO BE LENGTHENED OR SHORTENED TO MEET THE RIGHT-OF-WAY AT THE BEGINNING AND THE BOUNDARY PROJECTION AT THE POINT OF TERMINUS AND TO FORM A CLOSED FIGURE.

CONTAINING 138,939 SQUARE FEET (3.189 ACRES) MORE OR LESS.

ANY MODIFICATION OF THIS DESCRIPTION SHALL RENDER IT VOID.

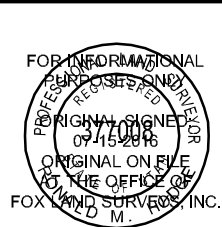

DESIGNED FOR:

verizon
wireless

9656 SOUTH PROSPERITY ROAD
WEST JORDAN, UTAH 84088

PROJECT NAME:
SAL BECKER

TAEC
Technology Associates Engineering Corporation Inc.
TECHNOLOGY ASSOCIATES

UTAH MARKET OFFICE / CORPORATE OFFICE
5710 SOUTH GREEN ST. / 3115 S. MELROSE DR., #110
SALT LAKE CITY, UT 84123 / CARLSBAD, CA 92010

FOX LAND SURVEYS INC
1515 S. Shoshone, Boise, Idaho 83705
www.foxlandsurveys.com
Tel: 208-342-7957

1414-34-MS
Sheet 3 of 3