

TEMPORARY TURNAROUND TO BE CONSTRUCTED PER WEBER COUNTY PUBLIC WORKS STANDARDS AND SPECIFICATIONS.

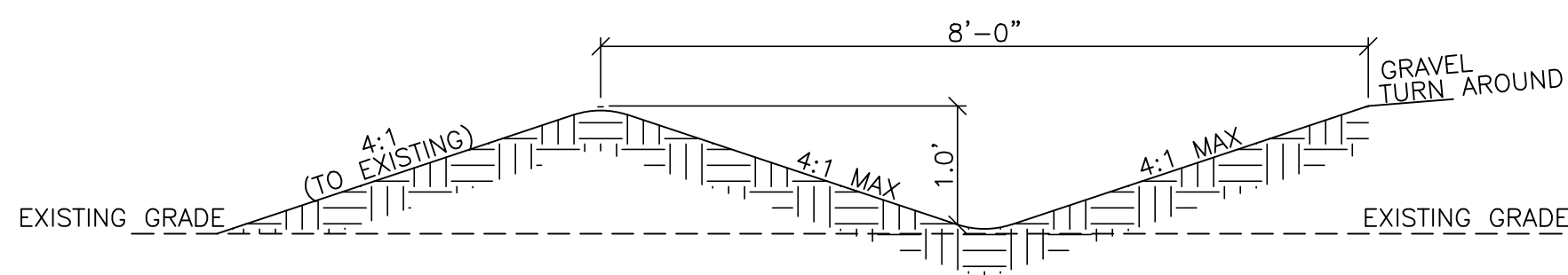

Drainage Ditch
SCALE: NONE

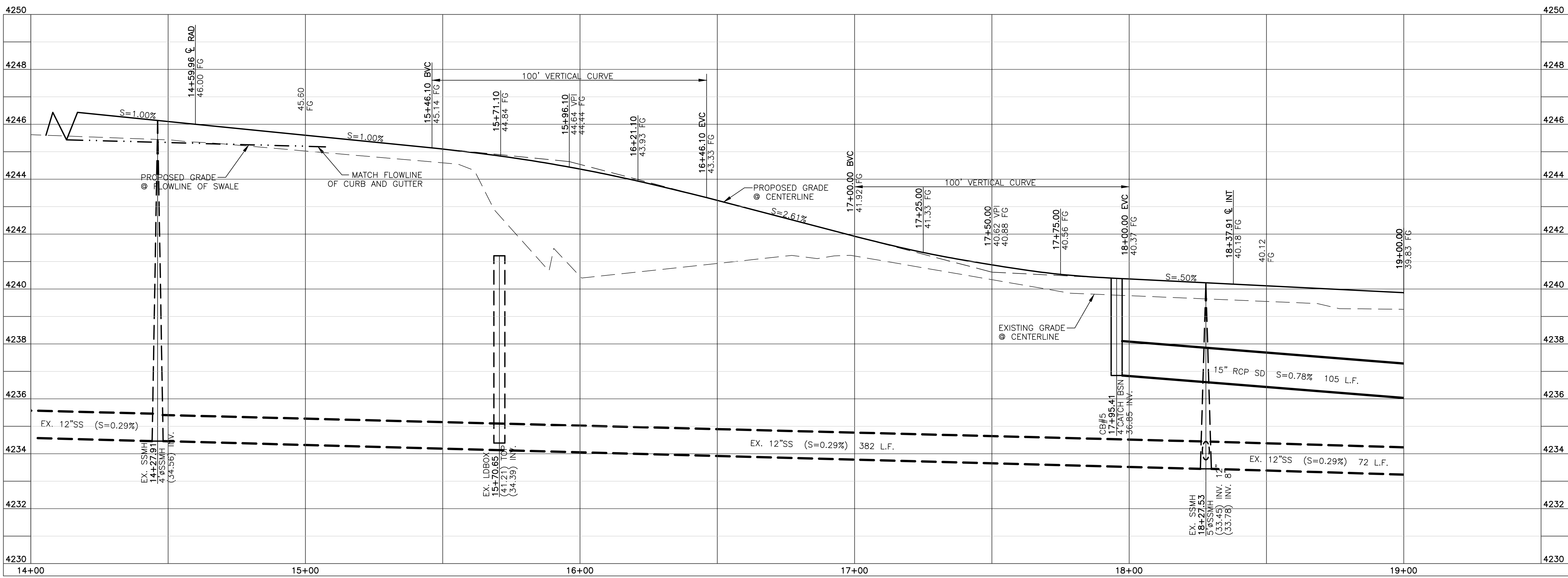
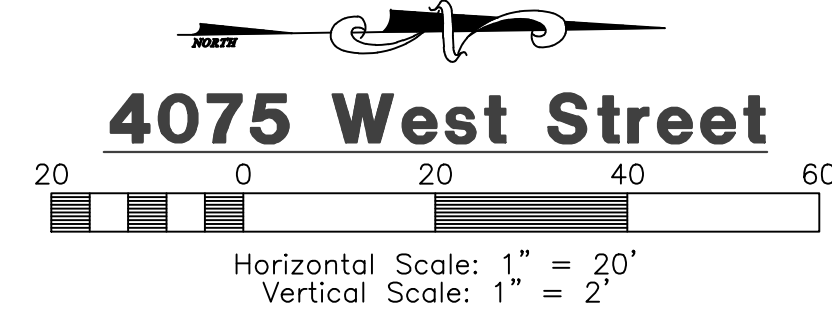

Blue Stakes Location Center
Call: Toll Free
1-800-662-4111
Two Working Days Before You Dig

Construction Notes:

- ALL CONSTRUCTION IS TO CONFORM TO THE STANDARD DRAWINGS AND SPECIFICATIONS OF WEBER COUNTY.
- CULINARY WATER**
W/10 - 10" PVC C-900 CLASS 200 WATER
- STORM DRAIN**
SD/15 - 15" RCP STORM DRAIN
SD/15 ARCH - 15" ARCH RCP STORM DRAIN
- SANITARY SEWER**
SS/8 - 8" PVC C-900 SEWER LINE
SS/12 - 12" PVC C-900 SEWER LINE
- SECONDARY WATER**
SW/8 - 8" PVC C-900 SECONDARY WATER LINE
- LAND DRAIN**
LD/8 - 8" PEFORATED PVC C-900 LAND DRAIN WRAPPED IN FABRIC

Reeve & Associates, Inc.
920 CHAMBERS STREET SUITE 14, OGDEN, UTAH 84403
TEL: (801) 621-3100 FAX: (801) 621-2666 www.reeve-assoc.com
LAND PLANNERS • CIVIL ENGINEERS • LAND SURVEYORS
TRAFFIC ENGINEERS • STRUCTURAL ENGINEERS • LANDSCAPE ARCHITECTS

| REVISIONS | DATE | DESCRIPTION |
|-----------|-------|--------------------|
| 1 | 12-15 | RH County Comments |
| 2 | 1-15 | RH County Comments |
| 3 | 2-11 | RH Client Changes |
| 4 | 3-17 | TP County Comments |
| 5 | 3-27 | TP County Comments |
| 6 | 2-25 | RH County Comments |
| 7 | 7-22 | RH County Comments |

Reeve & Associates, Inc. - Solutions You Can Build On

Blue Acres Subdivision
Phase-4
WEBER COUNTY, UTAH

4075 West Street
14+00.00 - 19+00.00

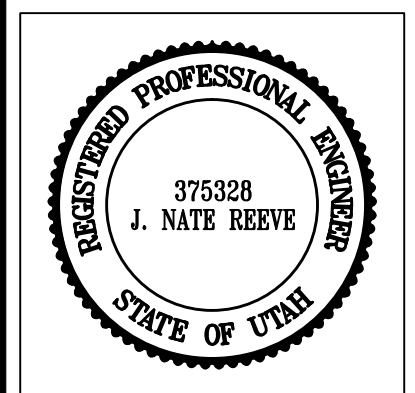

Project Info.

Engineer: J. NATE REEVE, P.E.
 Drafter: R. HANSEN
 Begin Date: JUNE 10, 2014
 Name: BLUE ACRES SUBDIVISION PHASE-4
 Number: 5036-01

| | |
|----------|----------|
| Sheet | 8 |
| 4 | Sheets |