

TEMPORARY TURNAROUND TO BE CONSTRUCTED PER WEBER COUNTY PUBLIC WORKS STANDARDS AND SPECIFICATIONS.



This is not shown correctly

radius of the??
directional ADA ramps
APWA
plan No. 238
Trans. 1
radius of the??

Construction Notes:

1) ALL CONSTRUCTION IS TO CONFORM TO THE STANDARD DRAWINGS AND SPECIFICATIONS OF WEBER COUNTY.

CULINARY WATER
 W/10 - 10" PVC C-900 CLASS 200 WATER

STORM DRAIN
 SD/15 - 15" RCP STORM DRAIN
 SD/15 ARCH - 15" ARCH RCP STORM DRAIN

SANITARY SEWER
 SS/8 - 8" PVC C-900 SEWER LINE
 SS/12 - 12" PVC C-900 SEWER LINE

SECONDARY WATER
 SW/8 - 8" PVC C-900 SECONDARY WATER LINE

LAND DRAIN
 LD/8 - 8" PERFORATED PVC C-900 LAND DRAIN WRAPPED IN FABRIC

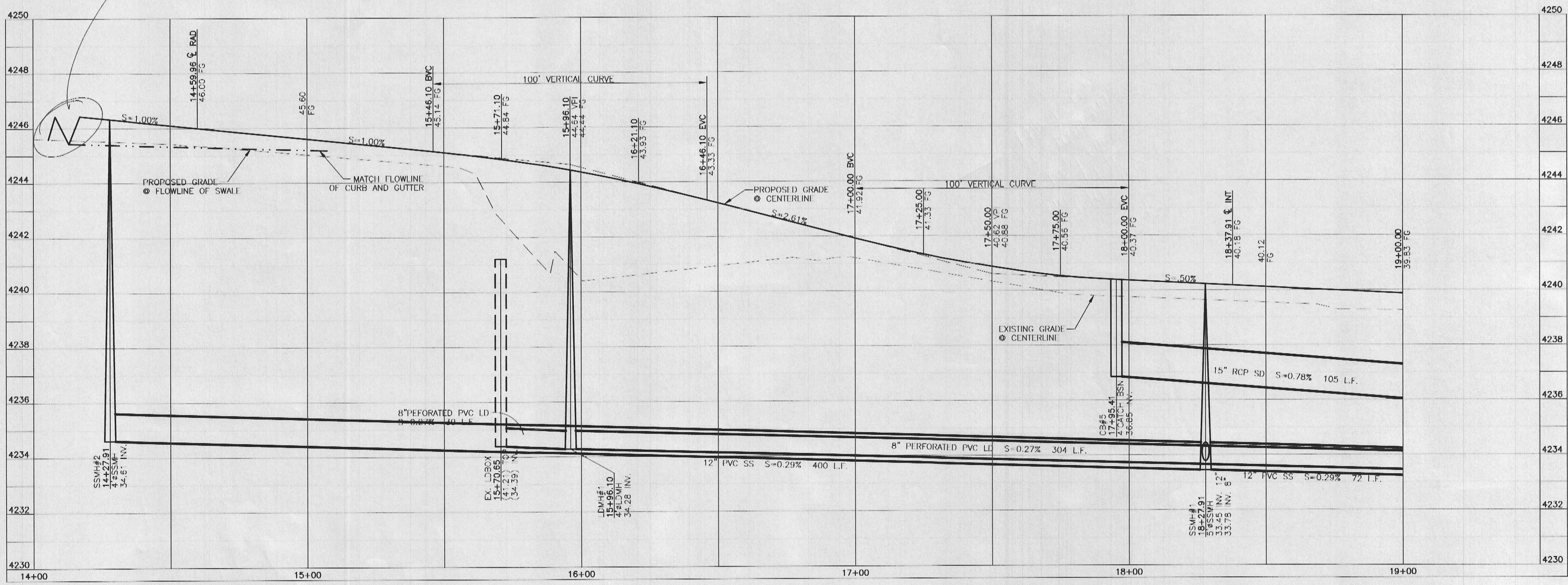

Blue Stakes Location Center
Call Toll Free 1-800-662-4111
 Two Working Days Before You Dig

Reeve & Associates, Inc.
 920 CHAMBERS STREET, SUITE 14, OGDEN, UTAH 84403
 TEL: (801) 671-3100 FAX: (801) 671-2668 WWW.REEVE-ASSOC.COM
 LEAD ENGINEERS & LAND SURVEYORS
 PROFESSIONAL ENGINEERS & LANDSCAPE ARCHITECTS



DATE	DESCRIPTION
3-3-12	Client Changes
1-12-15	City Comments
1-20-15	City Comments
2-11-15	City Comments
3-17-15	City Comments
3-27-15	City Comments

Blue Acres Subdivision Phase-4
 WEBER COUNTY, UTAH
4075 West Street
14+00.00 - 19+00.00

Revised: 3-27-15

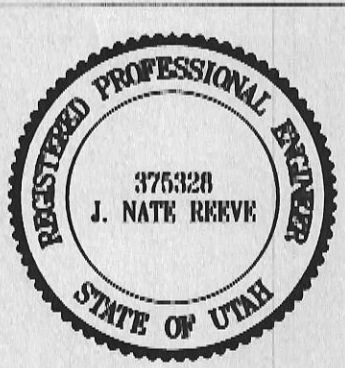

Project Info.
 Engineer: J. NATHAN REEVE, P.E.
 Drafter: R. HANSEN
 Begin Date: JUNI 10, 2014
 Name: BLUE ACRES SUBDIVISION PHASE-4
 Number: 5036-01

Sheet **8**
 4 Sheets