

LAKEVIEW SUBDIVISION

PART OF THE SOUTHWEST QUARTER OF SECTION 6 AND THE NORTHWEST QUARTER OF SECTION 7, TOWNSHIP 6 NORTH, RANGE 2 EAST, SALT LAKE BASE AND MERIDIAN, U.S. SURVEY
HUNTSVILLE CITY, WEBER COUNTY, UTAH
OCTOBER, 2014

BASIS OF BEARINGS

THE BASIS OF BEARINGS FOR THIS PLAT IS THE SECTION LINE BETWEEN THE NORTHWEST CORNER AND THE WEST QUARTER CORNER OF SECTION 6, TOWNSHIP 6 NORTH, RANGE 2 EAST, SALT LAKE BASE AND MERIDIAN, U.S. SURVEY. SHOWN HEREON AS: S00°19'03"W

NARRATIVE

THE PURPOSE OF THIS PLAT IS TO CREATE A TWO LOT SUBDIVISION. ALL BOUNDARY CORNERS THAT WERE NOT FOUND WERE SET WITH A 5/8" X 24" REBAR AND PLASTIC CAP STAMPED "REEVE & ASSOCIATES". THE RIGHT OF WAY FOR 7100 EAST STREET WAS BASED ON FOUND U.D.O.T. R.O.W. MONUMENTS ALONG THE EAST LINE OF SAID STREET

BOUNDARY DESCRIPTION

PART OF THE SOUTHWEST QUARTER OF SECTION 6 AND THE NORTHWEST QUARTER OF SECTION 7, TOWNSHIP 6 NORTH, RANGE 2 EAST, SALT LAKE BASE AND MERIDIAN, U.S. SURVEY. DESCRIBED AS FOLLOWS:

BEGINNING AT A POINT IN THE EAST RIGHT OF WAY LINE OF 7100 EAST STREET AS AS DETERMINED BY FOUND UDOT RIGHT OF WAY MONUMENTS, AT THE EXTENSION OF AN EXISTING FENCE LINE, SAID POINT BEING S00°39'37"W, 2656.37 FEET TO THE NW CORNER OF SECTION 7 AND S46°46'26"E, 136.16' FEET FROM THE WEST QUARTER CORNER OF SAID SECTION 6; THENCE ALONG SAID EXISTING FENCE LINE THE FOLLOWING 5 COURSES: (1) N82°32'21"E, 65.10 FEET; (2) N75°30'21"E, 244.01 FEET; (3) N55°25'58"E, 354.16 FEET; (4) N69°08'57"E, 481.19 FEET; (5) N83°43'03"E, 181.37 FEET TO ANOTHER EXISTING FENCE; THENCE ALONG SAID FENCE LINE S00°15'31"E, 809.24 FEET TO THE NORTHEAST CORNER OF CASEY ACRES SUBDIVISION; THENCE ALONG THE NORTH LINE OF SAID SUBDIVISION (N00°24'33"E, 369.37' FEET) TO THE EAST RIGHT OF WAY LINE OF 7100 EAST STREET; THENCE ALONG SAID RIGHT OF WAY MONUMENT ON THE EAST LINE OF 7100 EAST STREET, TO THE POINT OF BEGINNING. CONTAINING 740,825 SQUARE FEET, 17.007 ACRES

TP#1
0-11" SILT LOAM, GRANULAR STRUCTURE
11-53" SILT LOAM, MASSIVE STRUCTURE
53-71" LOAMY SAND, SINGLE GRAIN STRUCTURE

TP#2
0-11" SILT LOAM, GRANULAR STRUCTURE
11-60" SILT LOAM, MASSIVE STRUCTURE
60-74" LOAMY SAND, SINGLE GRAIN STRUCTURE

TP#3
0-12" SILT LOAM, GRANULAR STRUCTURE
12-74" SILT LOAM, MASSIVE STRUCTURE
74-85" LOAMY SAND, SINGLE GRAIN STRUCTURE

TP#4
0-14" SILT LOAM, GRANULAR STRUCTURE
14-73" SILT LOAM, MASSIVE STRUCTURE
73-86" LOAMY SAND, SINGLE GRAIN STRUCTURE

TP#5
0-12" SILT LOAM, GRANULAR STRUCTURE
12-61" SILT LOAM, MASSIVE STRUCTURE
61-81" LOAMY SAND, SINGLE GRAIN STRUCTURE

DEVELOPER:

JOHNATHAN & ALISA DUNN
1034 N. 7100 E.
HUNTSVILLE, UT 84317
801-824-5287

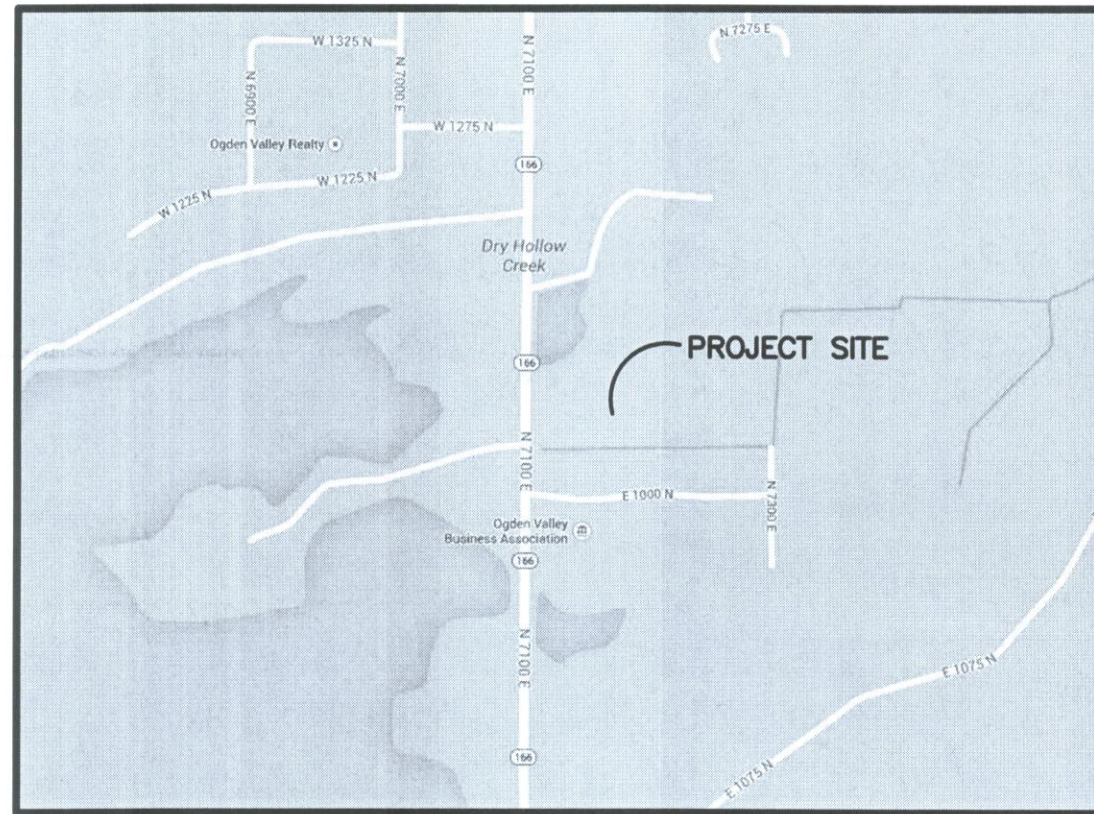

VICINITY MAP

NOT TO SCALE

N M H ENTERPRISES, LTD.
21-005-0009

AGRICULTURAL NOTICE

"AGRICULTURE IS THE PREFERRED USE IN THE AGRICULTURAL ZONES. AGRICULTURAL OPERATIONS AS SPECIFIED IN THE ZONING ORDINANCE FOR A PARTICULAR ZONE ARE PERMITTED AT ANY TIME INCLUDING THE OPERATION OF FARM MACHINERY AND NO ALLOWED AGRICULTURAL USE SHALL BE SUBJECT TO RESTRICTION ON THE BASIS THAT IT INTERFERES WITH ACTIVITIES OF FUTURE RESIDENTS OF THIS SUBDIVISION." (AMD, ORD. #3-82, JANUARY 26, 1982; ORD., #2002-3, MARCH 05, 2002)

LEGEND

- SECTION CORNER
- SET 5/8" X 24" REBAR AND PLASTIC CAP STAMPED "REEVE & ASSOCIATES"
- TEST PIT
- FOUND REBAR STAMPED HANSEN
- FOUND UDOT ROW MONUMENT
- BOUNDARY LINE
- ROAD CENTERLINE
- ROAD RIGHT OF WAY
- ADJOINING PROPERTY
- SECTION TIE LINE
- EXISTING FENCELINE
- EXISTING PAVEMENT
- EXISTING GRAVEL ROAD
- EXISTING STRUCTURE

NOTE:
DUE TO THE TOPOGRAPHY AND THE LOCATION OF THIS SUBDIVISION ALL OWNERS WILL ACCEPT RESPONSIBILITY FOR ANY STORM WATER RUNOFF FROM THE ROAD ADJACENT TO THIS PROPERTY UNTIL CURB AND GUTTER ARE INSTALLED.

WEBER COUNTY ATTORNEY

I HAVE EXAMINED THE FINANCIAL GUARANTEE AND OTHER DOCUMENTS ASSOCIATED WITH THIS SUBDIVISION PLAT, AND IN MY OPINION THEY CONFORM WITH THE COUNTY ORDINANCE APPLICABLE THERETO AND NOW IN FORCE AND AFFECT.
SIGNED THIS _____ DAY OF _____, 20____.

WEBER COUNTY ATTORNEY

WEBER COUNTY SURVEYOR

I HEREBY CERTIFY THAT THE WEBER COUNTY SURVEYOR'S OFFICE HAS REVIEWED THIS PLAT FOR MATHEMATICAL CORRECTNESS, SECTION CORNER DATA, AND FOR HARMONY WITH LINES AND MONUMENTS ON RECORD IN COUNTY OFFICES. THE APPROVAL OF THIS PLAT BY THE WEBER COUNTY SURVEYOR DOES NOT RELIEVE THE LICENSED LAND SURVEYOR WHO EXECUTED THIS PLAT FROM THE RESPONSIBILITIES AND/OR LIABILITIES ASSOCIATED THERewith.
SIGNED THIS _____ DAY OF _____, 20____.

WEBER COUNTY SURVEYOR

WEBER COUNTY COMMISSION ACCEPTANCE

THIS IS TO CERTIFY THAT THIS SUBDIVISION PLAT, THE DEDICATION OF STREETS AND OTHER PUBLIC WAYS AND FINANCIAL GUARANTEE OF PUBLIC IMPROVEMENTS ASSOCIATED WITH THIS SUBDIVISION, THEREON ARE HEREBY APPROVED AND ACCEPTED BY THE COMMISSIONERS OF WEBER COUNTY, UTAH.
SIGNED THIS _____ DAY OF _____, 20____.

CHAIRMAN, WEBER COUNTY COMMISSION

ATTEST

WEBER COUNTY ENGINEER

I HEREBY CERTIFY THAT THE REQUIRED PUBLIC IMPROVEMENT STANDARDS AND DRAWINGS FOR THIS SUBDIVISION CONFORM WITH THE COUNTY STANDARDS AND THE AMOUNT OF THE FINANCIAL GUARANTEE IS SUFFICIENT FOR THE INSTALLATION OF THESE IMPROVEMENTS.

WEBER COUNTY ENGINEER

WEBER COUNTY PLANNING COMMISSION APPROVAL

THIS IS TO CERTIFY THAT THIS SUBDIVISION PLAT WAS DULY APPROVED BY THE WEBER COUNTY PLANNING COMMISSION.
SIGNED THIS _____ DAY OF _____, 20____.

CHAIRMAN, WEBER COUNTY PLANNING COMMISSION

SURVEYOR'S CERTIFICATE

I, **ROBERT D. KUNZ**, DO HEREBY CERTIFY THAT I AM A REGISTERED PROFESSIONAL LAND SURVEYOR IN THE STATE OF UTAH IN ACCORDANCE WITH TITLE 58, CHAPTER 22, PROFESSIONAL ENGINEERS AND LAND SURVEYORS ACT; AND THAT I HAVE COMPLETED A SURVEY OF THE PROPERTY DESCRIBED ON THIS PLAT IN ACCORDANCE WITH SECTION 17-23-17 AND HAVE VERIFIED ALL MEASUREMENTS, AND HAVE PLACED MONUMENTS AS REPRESENTED ON THIS PLAT, AND THAT THIS PLAT OF **LAKEVIEW SUBDIVISION** IN **HUNTSVILLE CITY, WEBER COUNTY, UTAH**, HAS BEEN DRAWN CORRECTLY TO THE DESIGNATED SCALE AND IS A TRUE AND CORRECT REPRESENTATION OF THE HEREIN DESCRIBED LANDS INCLUDED IN SAID SUBDIVISION, BASED UPON DATA COMPILED FROM RECORDS IN THE **WEBER COUNTY** RECORDER'S OFFICE AND FROM SAID SURVEY MADE BY ME ON THE GROUND. I FURTHER CERTIFY THAT THE REQUIREMENTS OF ALL APPLICABLE STATUTES AND ORDINANCES OF **HUNTSVILLE CITY, WEBER COUNTY** CONCERNING ZONING REQUIREMENTS REGARDING LOT MEASUREMENTS HAVE BEEN COMPLIED WITH.

SIGNED THIS _____ DAY OF _____, 20____.



150228

UTAH LICENSE NUMBER

ROBERT D. KUNZ

OWNERS DEDICATION AND CERTIFICATION

WE THE UNDERSIGNED OWNERS OF THE HEREIN DESCRIBED TRACT OF LAND, DO HEREBY SET APART AND SUBDIVIDE THE SAME INTO A ONE LOT SUBDIVISION AS SHOWN ON THE PLAT AND NAME SAID TRACT **LAKEVIEW SUBDIVISION**, AND DO HEREBY DEDICATE TO PUBLIC USE ALL THOSE PARTS OR PORTIONS OF SAID TRACT OF LAND DESIGNATED AS STREETS, THE SAME TO BE USED AS PUBLIC THOROUGHFARES AND ALSO TO GRANT AND DEDICATE A PERPETUAL RIGHT AND EASEMENT OVER, UPON AND UNDER THE LANDS DESIGNATED HEREON AS PUBLIC UTILITY, STORM WATER DETENTION PONDS DRAINAGE EASEMENTS AND CANAL MAINTENANCE EASEMENT, THE SAME TO BE USED FOR THE INSTALLATION MAINTENANCE AND OPERATION OF PUBLIC UTILITY SERVICE LINE, STORM DRAINAGE FACILITIES, IRRIGATION CANALS OR FOR THE PERPETUAL PRESERVATION OF WATER CHANNELS IN THEIR NATURAL STATE WHICHEVER IS APPLICABLE AS MAY BE AUTHORIZED BY THE GOVERNING AUTHORITY, WITH NO BUILDINGS OR STRUCTURES BEING ERECTED WITHIN SUCH EASEMENTS.

SIGNED THIS _____ DAY OF _____, 20____.

NAMES/TRUST TO BE TYPED UNDER THE SIGNATURE LINES

ACKNOWLEDGMENT

STATE OF UTAH)ss.
COUNTY OF _____)

ON THE _____ DAY OF _____, 20____, PERSONALLY APPEARED BEFORE ME, THE UNDERSIGNED NOTARY PUBLIC, _____ (AND) _____ SIGNER(S) OF THE ABOVE OWNER'S DEDICATION AND CERTIFICATION, WHO BEING BY ME DULY SWORN, DID ACKNOWLEDGE TO ME _____ SIGNED IT FREELY, VOLUNTARILY, AND FOR THE PURPOSES THEREIN MENTIONED.

COMMISSION EXPIRES _____

NOTARY PUBLIC

ACKNOWLEDGMENT

STATE OF UTAH)ss.
COUNTY OF _____)

ON THE _____ DAY OF _____, 20____, PERSONALLY APPEARED BEFORE ME, THE UNDERSIGNED NOTARY PUBLIC, _____ (AND) _____ BEING BY ME DULY SWORN, ACKNOWLEDGED TO ME THEY ARE _____ AND _____ OF SAID CORPORATION AND THAT THEY SIGNED THE ABOVE OWNER'S DEDICATION AND CERTIFICATION FREELY, VOLUNTARILY, AND IN BEHALF OF SAID CORPORATION FOR THE PURPOSES THEREIN MENTIONED.

COMMISSION EXPIRES _____

NOTARY PUBLIC

Project Info.

Surveyor: **R. KUNZ**

Designer: **N. ANDERSON**

Begin Date: **10-15-14**

Name: **DUNN ESTATES**

SUBDIVISION

Number: **6379-01**

Revision: _____

Scale: **1"=80'**

Checked: **C.C.**



WEBER-MORGAN HEALTH DEPARTMENT

I HEREBY CERTIFY THAT THE SOILS, PERCOLATION RATES, AND SITE CONDITIONS FOR THIS SUBDIVISION HAVE BEEN INVESTIGATED BY THIS OFFICE AND ARE APPROVED FOR ON-SITE WASTEWATER DISPOSAL SYSTEMS.
SIGNED THIS _____ DAY OF _____, 20____.

WEBER-MORGAN HEALTH DEPARTMENT

Webster County Recorder

Entry No. _____ Fee Paid _____

And Recorded, _____

At _____ In Book _____

Of The Official Records, Page _____

Recorded For: _____

_____ Weber County Recorder

_____ Deputy.