

Weber County Stormwater Construction Activity Permit

Application submittals will be accepted by appointment only. (801) 399-8374. 2380 Washington Blvd. Suite 240, Ogden, UT 84401

Date Submitted <i>Oct. 4, 2014</i>	Fees (Office Use) _____	Receipt Number (Office Use) _____	Priority Site (Office Use) <input type="radio"/> Yes <input checked="" type="radio"/> No	Permit Number (Office Use) <i>2014-77</i>
---------------------------------------	----------------------------	--------------------------------------	---	--

Property Owner/Authorized Representative Contact Information		Project Information	
Name of Property Owner(s)/Authorized Representative(s) <i>Corey & Rebecca Erdmann</i>		Project Name <i>Valley Green Estates #1 Lot 7</i>	
Phone <i>801-941-7278</i>	Fax _____	Project Address <i>2701 So. 4150 W. Ogden, Ut. 84401</i>	
Email Address _____			
Mailing Address of Property Owner(s)/Authorized Representative(s) <i>Rod Herrick 934 So. 3500 W. Ogden, Utah 84404</i>		Estimated Project Length (mo) <i>9 months</i>	Previous Permit No. (if applicable) _____
		Estimated Start Date <i>Oct. 15, 2014</i>	Actual Start Date _____

Submittal Checklist

The application shall include a Storm Water Pollution Prevention Plan which meets the criteria set forth in Section 33-3-4 of the county ordinances.

The applicant shall file the application on or before the following dates:

Subdivision: The date that the applicant submits the preliminary subdivision development plat application.

Site Plan: The date that the applicant submits a site plan application or amended site plan.

Building Permit: The date that the applicant submits a building permit application if the applicant proposes to construct a building on an existing lot or parcel.

Land Use Permit: The date that the applicant submits a land use permit application.

Other: At least two (2) weeks before the developer intends to perform any type of work not listed above that would require a Storm Water Construction Activity Permit pursuant to this Chapter.

Failure to acquire a required Storm Water Construction Activity Permit is grounds for tabling a related subdivision application, site plan application, conditional use permit application, or building permit application. It is unlawful to commence work (move dirt) on a development site before obtaining a required Storm Water Construction Activity Permit.

Note: A pre-construction meeting is required before performing any on-site earth work, unless waived by the county engineer.

Applicant Narrative

Please explain your request.

Single Family Dwelling

Authorization

By signing below the Owner / Representative authorizes the county to enter the property to perform inspections.

Owner or Authorized Representative Signature <i>Rodney J. Herrick</i>	Date <i>Oct. 4, 2014</i>
Signature of Approval <i>Rebecca Erdmann</i>	Date <i>9-9-14</i>

Covey & Rebecka Erdmann

2701 So. 4150 W.

Lot # 7

Valley Green Estates # 1

Ogden, Ut. 84401

BASIC SWPPP EXAMPLE STORMWATER POLLUTION PREVENTION PLAN

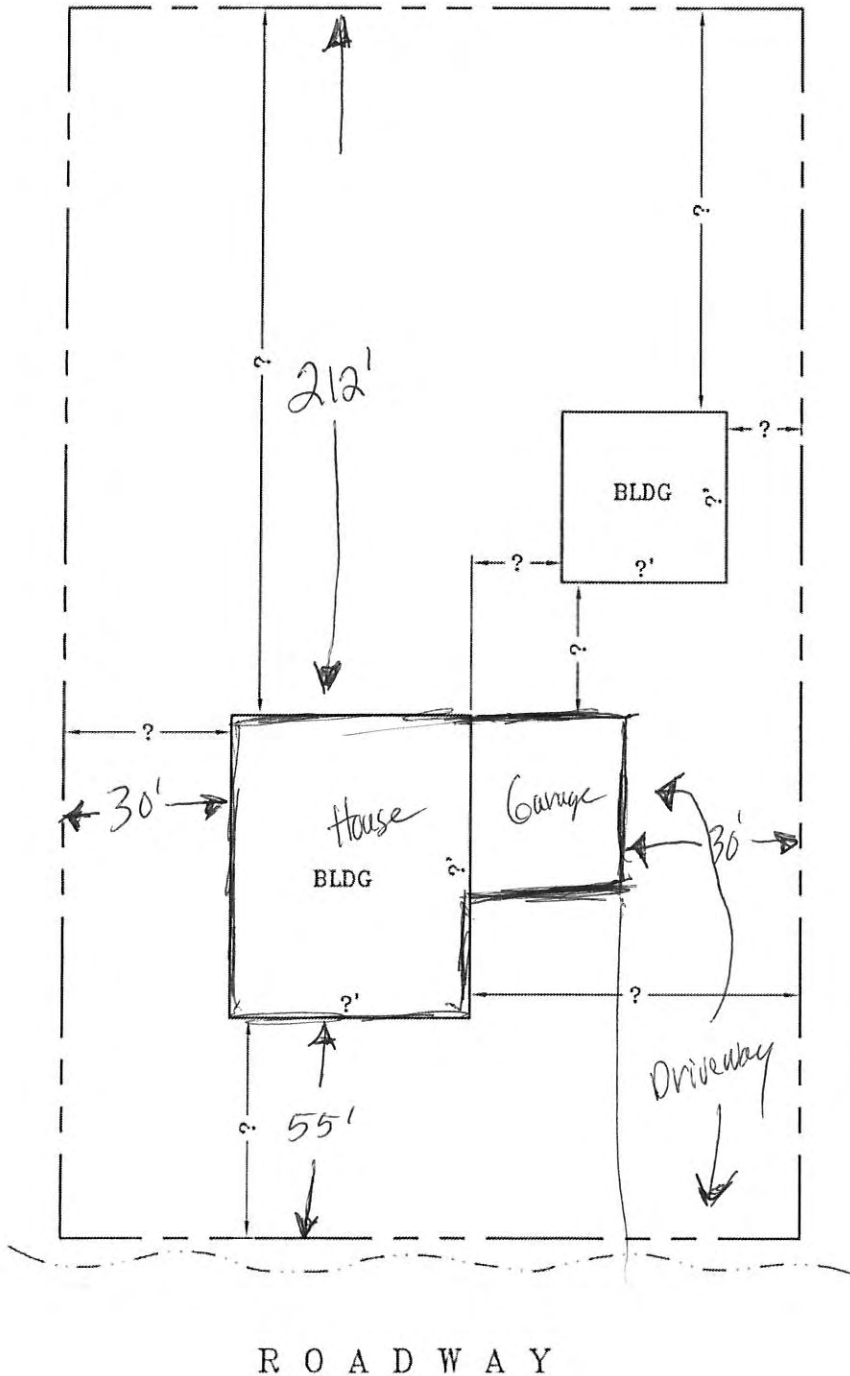

1. HOW MUCH AREA WILL BE DISTURBED? *2500 sq. ft.*
2. WHO WILL BE RESPONSIBLE FOR THE CONDITIONS OF THE SITE DURING CONSTRUCTION? *Red Hemick*
3. WHAT WILL BE DONE TO PREVENT THE NEIGHBORS FROM BEING AFFECTED BY THE PROPOSED CONSTRUCTION ACTIVITIES? *Dumpster on job Site &*
4. WHAT WILL BE DONE WITH ALL EXCAVATED MATERIAL TEMPORARILY AND PERMANENTLY? *Backfill Lot*
5. WHERE IS THE CONCRETE WASHOUT & HOW WILL IT BE MAINTAINED? *in Gravel North Driveway*
6. WHERE ARE THE PORTA-JOHN'S LOCATED AND HOW ARE THEY INSTALLED? *Front North Driveway*
7. HOW WILL THE CONSTRUCTION ENTRANCE BE BUILT AND WHERE WILL IT BE LOCATED? *Gravel North Driveway*
8. WHAT WILL YOU DO WHEN MUD AND/OR DIRT GETS TRACKED ON THE ASPHALT? *clean & sweep*
9. IS THERE A DRAINAGE DITCH OR SWALE ON OR NEAR YOUR PROPERTY? HOW WILL IT BE PROTECTED? *Front Property Private Ditch*
10. WHAT CURRENTLY HAPPENS TO THE RAIN/STORM WATER WHEN IT REACHES THIS PROJECT SITE? *Subs in ground.*
11. SHOW ALL EXISTING OCCUPATION ON THE PROPERTY. *None*